

REQ. PER. UNIT	USED ON			TE-177
	MODEL	ASSY. NO.	DATE	
1	GPT-10K	AJ-100	12-15-59	

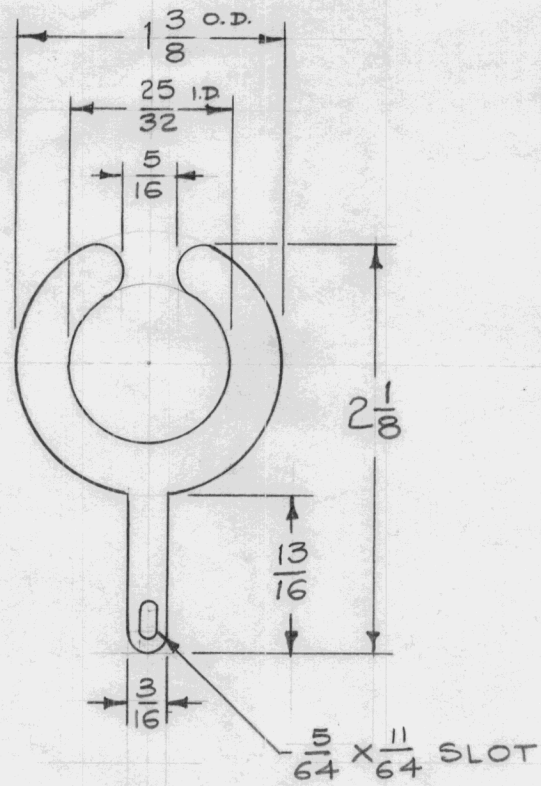

Ref-Zierick Mfg. Corp. #129

ISSUE	ITEM	CHANGED FROM	DATE	CH. NO.	DRAFTS	CHECKER	ENG. APP.	REQ. ITEM	PART NO.	DESCRIPTION	SYMBOL	
								.020 Thick		THE TECHNICAL MATERIEL CORP.		
								STOCK SIZE		MAMARONECK, NEW YORK		
								Brass		LUG, TERMINAL, HORSESHOE		
								MATERIAL				
										16 ^{12/15/59}	<i>[Signature]</i>	
TOLERANCES			SCALE:								<i>[Signature]</i>	
DEC. DIM. ± FRAC. DIM. ± ANGULAR DIM. ±			MAXIMUM ALLOWABLE TOLERANCES HAVE BEEN DETERMINED AND ANY DEVIATIONS WILL BE CAUSE FOR REJECTION. REMOVE ALL BURRS AND SHARP EDGES					TYPE & TEMPER	HEATTREAT. SPEC.	DRAWN	CHECKED	FINAL APPROVAL
								Hot Tinned				TE-177
								FINISH & SPEC. NO.	ELEC. DES. APP	MECH. DES. APP		