

THE CONTENTS OF THIS DRAWING ARE THE EXCLUSIVE PROPERTY OF THE TECHNICAL MATERIEL CORP. ITS UNAUTHORIZED USE FOR REPRODUCTION IN WHOLE OR IN PART IS STRICTLY FORBIDDEN.

REQ. PER UNIT

5

USED ON

MODEL

GPR-92

ASS'Y. NO.

DATE

6-13-63

PX-828

B

HOLE	DESCRIPTION	REQ'D
A	5/32 DIA.	7
B	3/8 DIA.	1

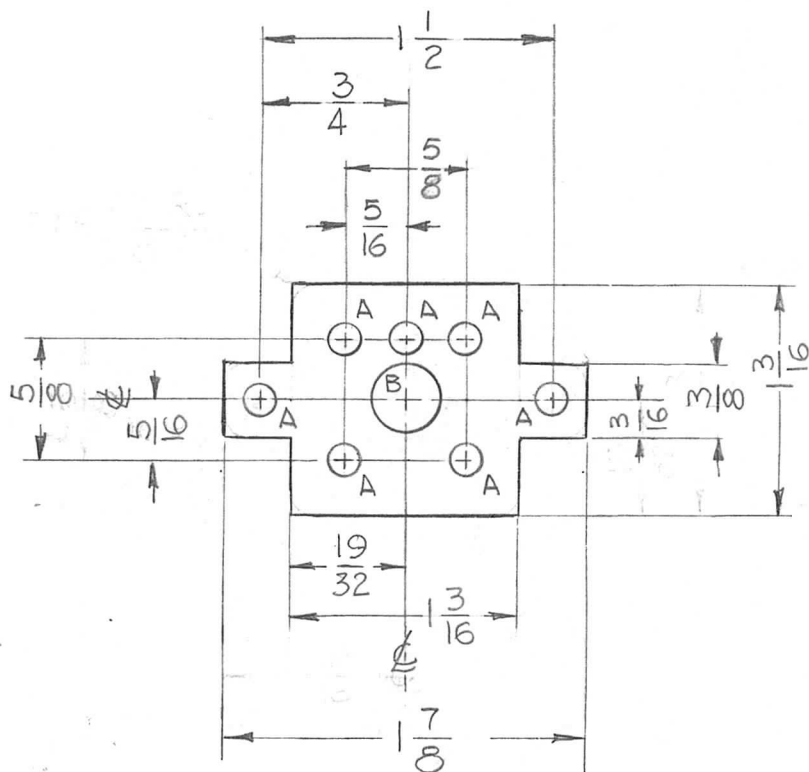

REQ.	ITEM	PART NO.	STRUHER DESCRIPTION	SYMBOL									
		11/76 THK	THE TECHNICAL MATERIEL CORP. MAMARONECK, NEW YORK	INSULATOR, I F									
		STOCK SIZE											
B	ALL 1/8 RADIUS DELETED	4/28/64 11305 A.M.											
A	IN STOCK SIZE BLOCK 1/16 WAS 1/32 IN HOLE CHART 3/8 D. WAS 11/32 D.	10/14/63 10180	PHENOLIC										
SYM	DESCRIPTION	DATE	CH. NO.	DRAFTS	CHECKER	ENG. APP.	MATERIAL						
UNLESS OTHERWISE SPECIFIED DIMENSIONS ARE IN INCHES AND INCLUDE CHEMICALLY APPLIED OR PLATED FINISHES		SCALE		1:1		XXX P		GDL	JDE 7/8/63	TFH	7.8.63		
DECIMALS .X ± .05 .XX ± .01 .XXX ± .005		TOLERANCES		FRACTIONS ± 1/64 ANGLES ± 0° 30'		CODE		TYPE & TEMPER	HEAT TREAT. SPEC.	DRAWN	CHECKED	FINAL APPROVAL	
								NATURAL		JM	MP 7/8/63	PX-828	B
								FINISH & SPEC. NO.	ELEC. DES. APP.	MECH. DES. APP.			