

- HOLE LEGEND**
- A - 7/32 (.218) DIA. 8-REQ.
 - B - HOLES TO BE MACHINED AS FOLLOWS 3-REQ.
 - 1- 13/64 DRILL (.203) TO .562 DP.
 - 2- 120° C'SINK. .22-.25 DIA.
 - 3- TAP .410 MIN. DEPTH, USE HELI COIL TAP # 3 FPB
 - 4- MOUNT ITEM (1) 3/4 TO 1-1/2 PITCH BELOW SURFACE
 - 5- BREAK OFF DRIVING TANG.
 - C - 1-1/4 (1.250) DIA. x .183 ± .002 DEEP 5
 - D - 11/16 DIA. x 1/8 DEEP 4
 - E - 4 1/64 (.640) DIA. 1
 - F - 9/32 DIA. THRU, Then C'Sink. 5

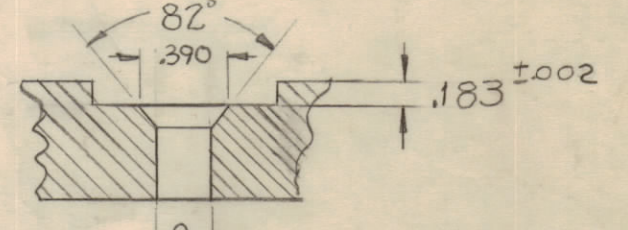

G - 1/2 x 1 3/4 SLOTS 7 REQ

* ITEM 1 IS ACCEPTABLE AS PHOSPHOR BRONZE OR STAINLESS STEEL.

THE TECHNICAL MATERIEL CORPORATION
MAMARONECK, NEW YORK

ISSUE	ZONE	DESCRIPTION	DATE	CH. NO.	DRAFTS	CHECKER	ENG. APP.
K		NOTE * ADD.	6/23/60	19911	H+	FB	FB
J	2	ON "F" DETAIL TOLER. WAS ± .005	8-26-60	12168	WB	GC	GC
J	1	ON "C" HOLE TOLER. WAS ± .005					
H	2	ITEM (1) ADDED	8-10-62	7008	GS	GC	GC
H	1	"B" HOLES WERE DR. & TAP 10-32 x 3/4 DP.					
G	1	"B" HOLES WERE DR. & TAP For B-32 x 3/4	7-31-61	4971	RU	GC	GC
F	2	C WAS 1/4 D x 3/32 DP	9-8-60	2917	RU	GC	GC
F	1	DIM .183 ± .005 WAS ADDED ON "G"					
E	1	"G" SLOTS WERE 5/8 x 1 3/4	8-19-60	2833	RU	GC	GC
D	2	7 "G" SLOTS ADDED	7/5/60	2648	JLB	GC	GC
D	1	(7) "D" HOLES DELETED					
C	2	FOUR "D" HOLES ADDED					
C	1	"C" HOLE WAS 1/8 DP. x 1/4 D.	4-8-60	2113	WB	GC	GC
B		"D" HOLES WERE 9/16 D	3-21-60		WB	GC	GC
A		REDRAWN & REVISED	3/11/60		WB	GC	GC

REQ.	ITEM	PART NO.	DESCRIPTION	SYMBOL
3	1	NT-139-SFI-20 *	INSERT, SCREW THREAD	
		1/2	STOCK SIZE	
		SUPRA MICA 500	PLATE, SWITCH ANT. TUNER	
			MATERIAL	
			TYPE & TEMPER	
			HEAT TREAT. SPEC.	
			FINISH & SPEC. NO.	

REQ PER UNIT	MODEL	SECTION	ASSY. NO.	DATE
1	GPT-40K	AT-106		3-11-60