

PX-520 A

3 HOLES (.062)D.
FOR
PIN - PN-99-62-16

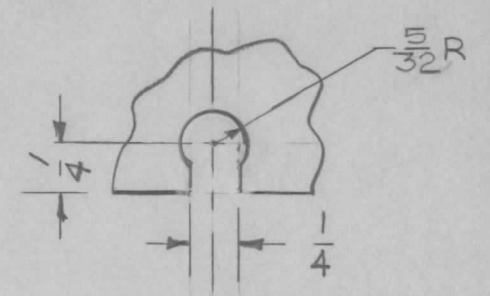
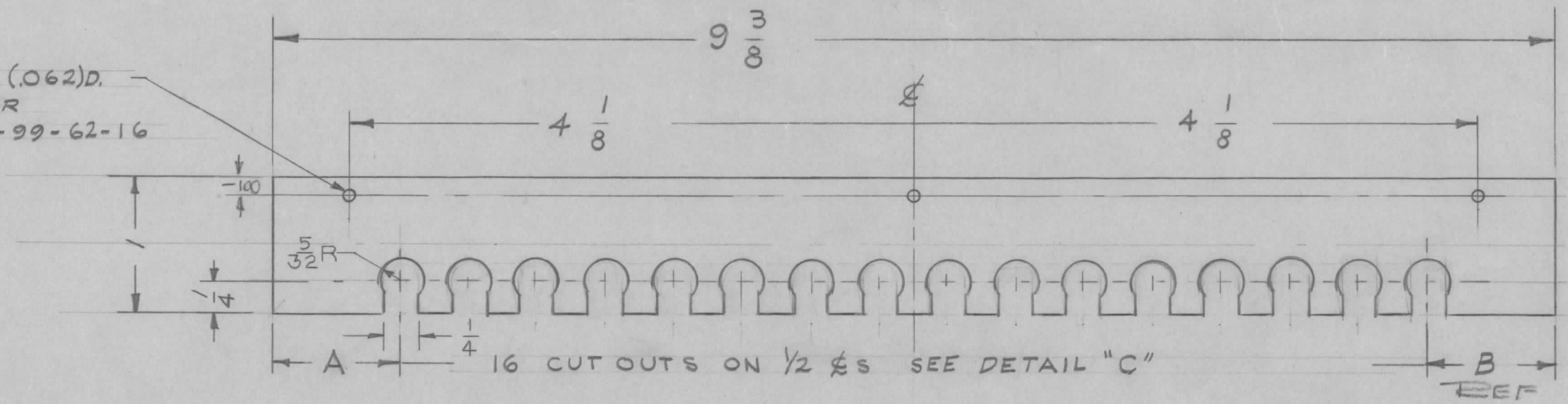

DETAIL "C"
16 REQ. ON 1/2 & S.

TMC PART No.	DIM A	DIM B REF.
PX-520-1	15/16	15/16
PX-520-2	1 1/16	13/16
PX-520-3	1 3/16	11/16
PX-520-4	1 5/16	9/16

ISSUE	ITEM	CHANGED FROM	DATE	CH. NO.	DRAFTS	CHECKER	ENG. APP.
A	1	ADD 5/32R & 1/4 ON "C" DETAIL	3/30/60			<i>CS</i>	<i>Jude</i>

TOLERANCES

SCALE:

DEC. DIM. ±
FRAC. DIM. ±
ANGULAR DIM. ±

MAXIMUM ALLOWABLE TOLERANCES HAVE BEEN DETERMINED AND ANY DEVIATIONS WILL BE CAUSE FOR REJECTION.
REMOVE ALL BURRS AND SHARP EDGES

1 EACH GPT-40K AT-101

REQ. PER UNIT

MODEL PROJECT NO. ASS'Y. NO. DATE

USED ON

REQ. ITEM	PART NO.	DESCRIPTION	SYMBOL
1/4"		THE TECHNICAL MATERIEL CORP. MAMARONECK. NEW YORK	
	STOCK SIZE	INSERT, COIL SUPPORT	
	TEFLON	COIL ANT. TUNER	
	MATERIAL		
		<i>TORILLO</i>	<i>J R</i>
		DRAWN	CHECKED
			FINAL APPROVAL
			<i>WJC</i>
			PX-520 A
		FINISH & SPEC. NO.	ELEC. DES. APP. MECH. DES. APP.