

THE CONTENTS OF THIS DRAWING ARE THE EXCLUSIVE PROPERTY OF THE TECHNICAL MATERIEL CORP. ITS UNAUTHORIZED USE FOR REPRODUCTION IN WHOLE OR IN PART IS STRICTLY FORBIDDEN.

REQ. PER UNIT

MODEL  
GPT-200K (AS-124)

USED ON

ASS'Y. NO.  
A-2682

DATE  
5-29-63

PM-916

Ø

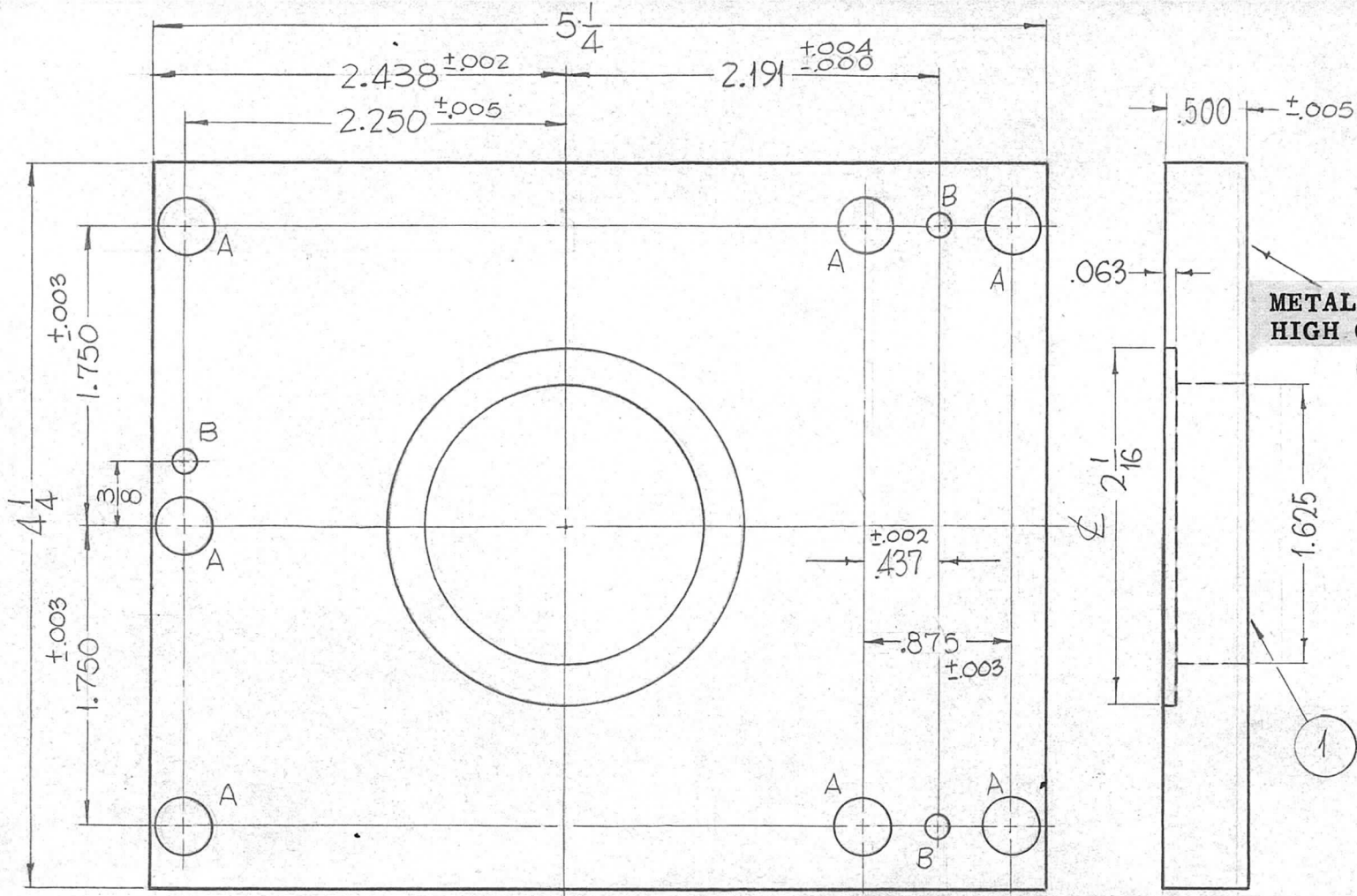

**HOLES:**  
A ~ 5/16 DIA. — 7 REQ.  
B ~ .128 DIA. — 3 REQ.

**METAL STAMP TMC PART NO. 1/8 HIGH GOTHIC ON REAR (PM-916-0)**

**NOTE:**  
BEARING TO BE WRINGING FIT (CLASS-5) INSERTED AFTER MACHINING & IRIDITING.  
METAL STAMP TMC PART NO. 1/8 HIGH GOTHIC AS SHOWN.

FRONT VIEW

							1	1	BB-120-4	BEARING, RACE		
							REQ. ITEM	PART NO.		F. BUDETTI	DESCRIPTION	SYMBOL
							SEE DWG.			THE TECHNICAL MATERIEL CORP. MAMARONECK, NEW YORK		
							STOCK SIZE			PLATE, BEARING RETAINER 2ND. PT.		
							ALUMINUM					
							MATERIAL					
							2024-T3		SRG	09905	RJC	4-7-64
							TYPE & TEMPER		HEAT TREAT. SPEC.		DRAWN	
							5404 YELLOW IRIDITE				CHECKED	
							FINISH & SPEC. NO.		ELEC. DES. APP.		MECH. DES. APP.	
											PM-916	
											Ø	

ORIGINAL RELEASE FOR PRODUCTION

SYM	DESCRIPTION	DATE	CH. NO.	DRAFTS	CHECKER	ENG. APP.
UNLESS OTHERWISE SPECIFIED DIMENSIONS ARE IN INCHES AND INCLUDE CHEMICALLY APPLIED OR PLATED FINISHES		SCALE 1" = 1"				
DECIMALS .X ± .05 .XX ± .01 .XXX ± .005	TOLERANCES	FRACTIONS ± 1/64 ANGLES ± 0° 30'	CODE A			