

REQ. PER UNIT	USED ON			PM1310	Ø
	MODEL	ASS'Y. NO.	DATE		
2	TLAA-2.5K	A5541	6-10-66		

HOLE	DESCRIPTION	REQ
A	.144 D. C'SK 82° TO .284 DIA	4
B	3/8 DIA	4

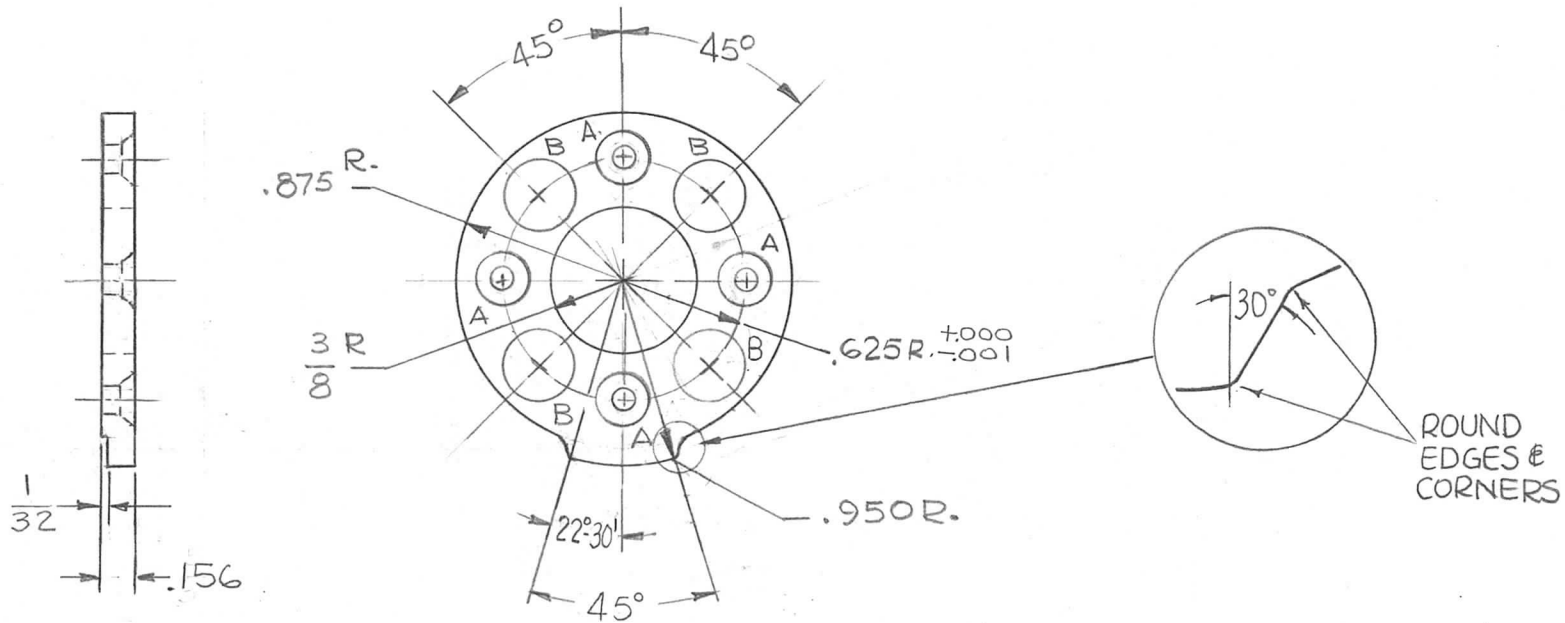

NOTE:
USED WITH GR229

Ø	ORIGINAL RELEASE FOR PRODUCTION	2/23/67	B	CV			REQ. ITEM	PART NO.	BUDETTI	DESCRIPTION	SYMBOL
X2	45° WAS 32.5°, 22.30' WAS 16.2°	2-17-67		<i>[Signature]</i>	<i>[Signature]</i>	<i>[Signature]</i>	AS NOTED		THE TECHNICAL MATERIEL CORP. MAMARONECK, NEW YORK		
X1	EXP RELEASE	11-28-66	X1	<i>[Signature]</i>	<i>[Signature]</i>	<i>[Signature]</i>	STOCK SIZE		CAM		
X	EXPERIMENTAL RELEASE	6/16/66	#	GOL	<i>[Signature]</i>	<i>[Signature]</i>	BRASS				
							MATERIAL				
SYM	DESCRIPTION	DATE	CH. NO.	DRAFTS	CHECKER	ENG. APP.	HALF HARD		G.D.L.	<i>[Signature]</i>	<i>[Signature]</i>
UNLESS OTHERWISE SPECIFIED DIMENSIONS ARE IN INCHES AND INCLUDE CHEMICALLY APPLIED OR PLATED FINISHES		SCALE		1:1			TYPE & TEMPER	HEAT TREAT. SPEC.	DRAWN	CHECKED	FINAL APPROVAL
DECIMALS .X ± .05 .XX ± .01 .XXX ± .005	TOLERANCES	FRACTIONS ± 1/64 ANGLES ± 0° 30'	CODE				NATURAL			<i>[Signature]</i>	DM1310
							FINISH & SPEC. NO.	ELEC. DES. APP.	MECH. DES. APP.		Ø