

DL-181

SPECIFICATIONS

SERIES ~ QDL
 NO OF CONTACTS ~ ONE (1)
 TYPE OF CONTACT ~ ROUND MALE
 DIELECTRIC ~ TEFLON

ELECTRICAL DATA

MAX. PEAK VOLT. ~
 NOM. IMPEDANCE ~ 50Ω

CABLE ACCOMODATIONS

TYPE ~ STYROFLEX
 MAX. O.D. ~ 7/8
 IMPEDANCE ~ 50Ω

MATERIAL

EXT. PARTS ~ BRASS
 CONTACT ~ BERYLLIUM COPPER
 INSULATION ~ LOW LOSS PLASTIC
 DIELECTRIC (TEFLON)
 CLAMP ~ STAINLESS STEEL

FINISH

EXT. PARTS ~ SILVER PLATE W/RHODIUM FLASH.
 CONTACT ~ SILVER PLATE W/GOLD FLASH.

NOTICE TO PERSONS RECEIVING THIS DRAWING

THE TECHNICAL MATERIEL CORPORATION claims proprietary right in the material disclosed herein. This drawing is issued in confidence for engineering information only and may not be reproduced or used to manufacture anything shown hereon without permission from THE TECHNICAL MATERIEL CORPORATION to the user. This drawing is loaned for mutual assistance and is subject to recall at any time.

Property of:

THE TECHNICAL MATERIEL CORPORATION
 MAMARONECK, NEW YORK

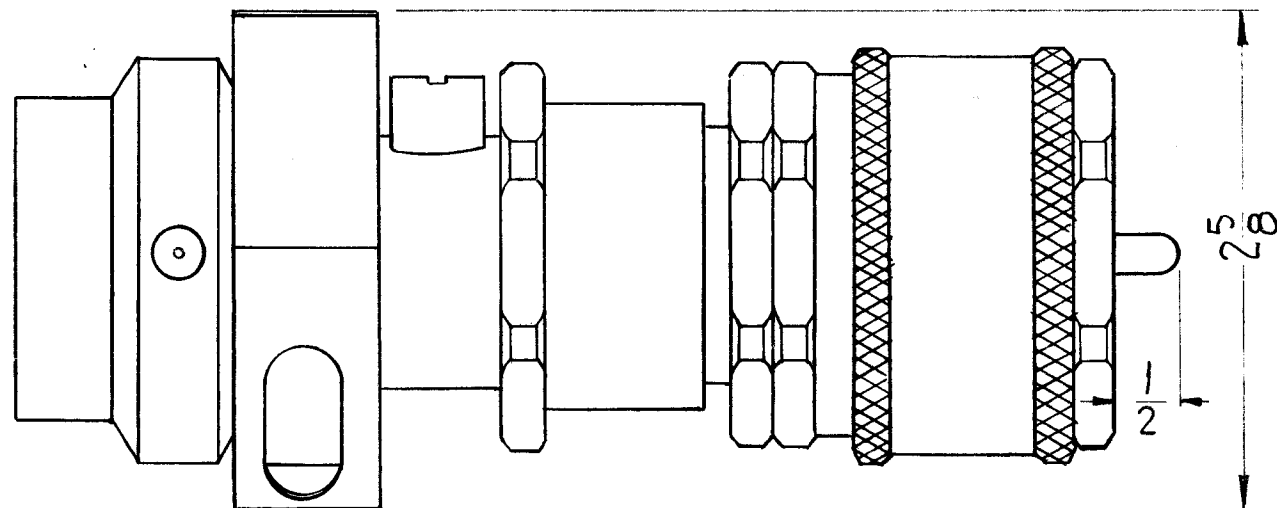

SYM	DESCRIPTION	DATE	CH. NO.	DRAFTS	CHECKER	ENG. APP.

UNLESS OTHERWISE SPECIFIED:
 DIMENSIONS ARE IN INCHES
 TOLERANCES ON FRACTIONS ± 1/64 DECIMALS ± .005 ANGLES ± 1/2°

SCALE: S-401-70 (9203)

MAXIMUM ALLOWABLE TOLERANCES HAVE BEEN DETERMINED AND ANY DEVIATIONS WILL BE CAUSE FOR REJECTION. REMOVE ALL BURRS AND SHARP EDGES

REQ. PER UNIT	MODEL	SECTION	ASS'Y. NO.	DATE
				5-23-61

USED ON

REQ. ITEM	PART NO.	DESCRIPTION	SYMBOL
		THE TECHNICAL MATERIEL CORP. MAMARONECK, NEW YORK	
		CONNECTOR, ADAPTER 7/8"-50Ω STYROFLEX TO QDL PLUG	
		D.D. [Signature] [Signature] [Signature]	
		TYPE & TEMPER HEAT TREAT. SPEC. DRAWN CHECKER FINAL APPROVAL	
		FINISH & SPEC. NO. ELEC. DES. APP. MECH. DES. APP.	PL-181