

MS-995 B

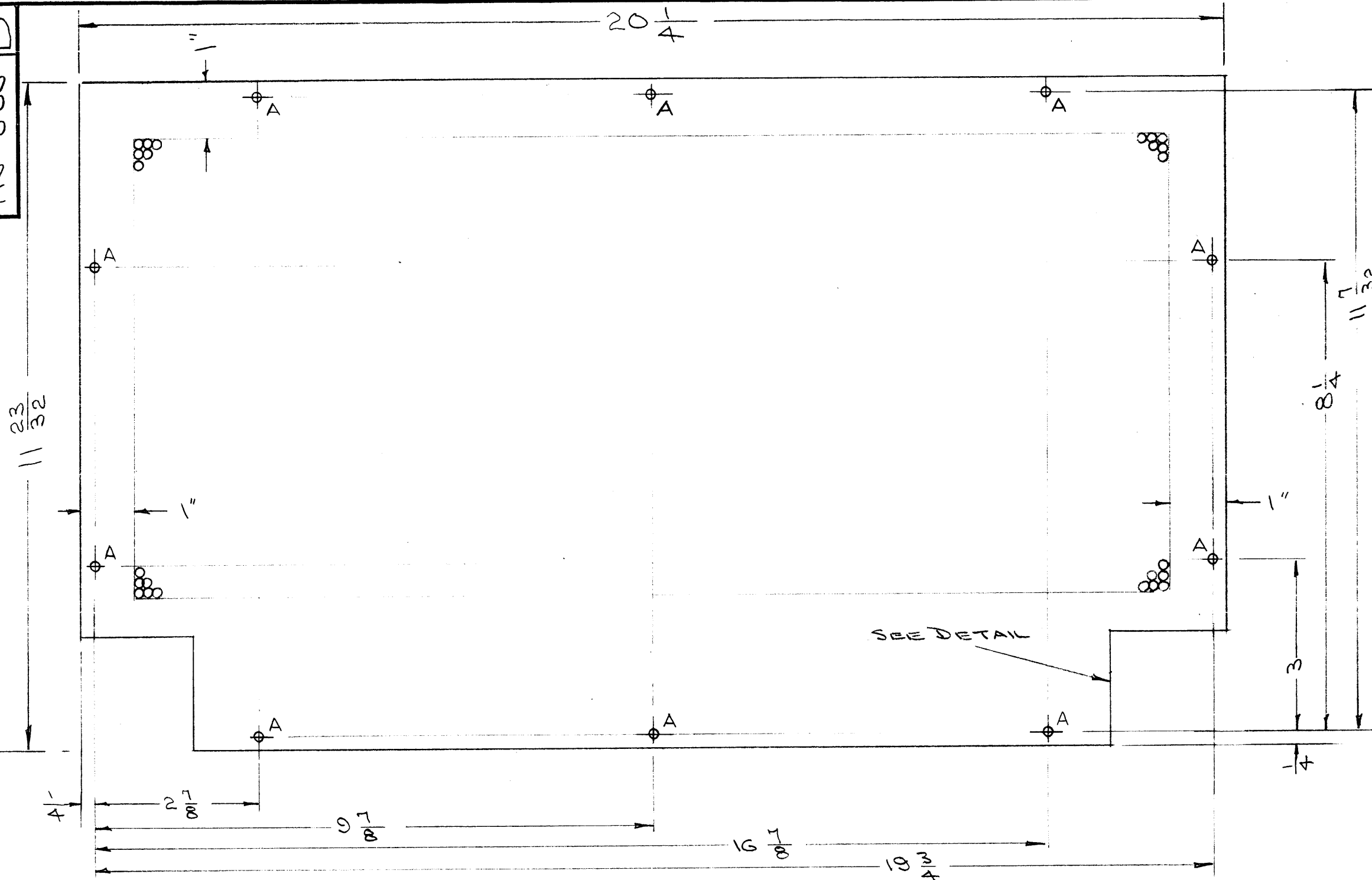

A- $\frac{3}{16}$  DIA. 10 REQ.

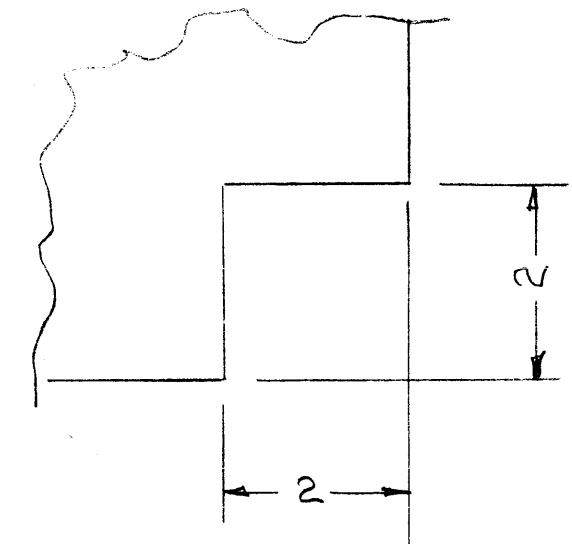

NOTCHING DETAIL  
2 REQ. AS SHOWN

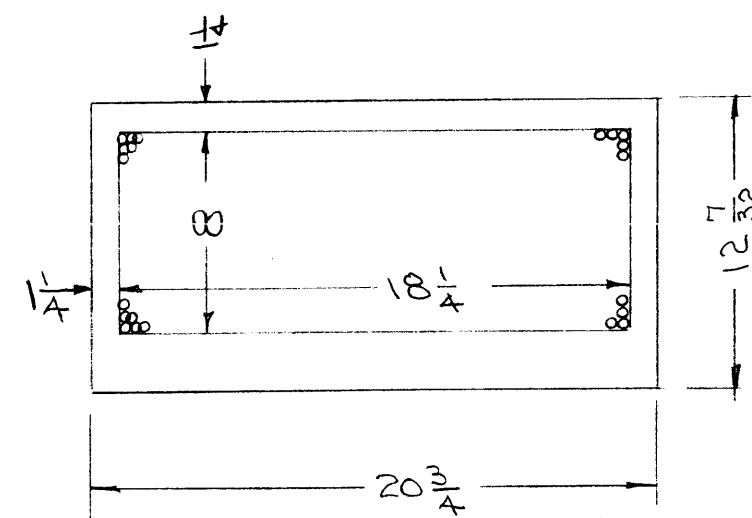

PURCHASED BLANK LAYOUT

PERFORATIONS:

PERFORATED HOLES - STAGGERED .150 DIA. HOLES ON  $\frac{3}{16}$  CENTERS. 33 HOLES PER SQ. IN.

FINISH:

S-404 YELLOW IRIDITE

REF: MS-994 (CABINET)

ISSUE	ITEM	CHANGED FROM	DATE	CH. NO.	DRAFTS	CHECKER	ENG. APP.
B	1	HOLES DESIGNATED	1-4-62	6149	L.L.	<del>EMN</del>	EMN
A	1	S-404 WAS S-101	12/14/54	1001	HB		EMN
TOLERANCES		SCALE:					
DEC. DIM. $\pm$		MAXIMUM ALLOWABLE TOLERANCES HAVE BEEN DETERMINED AND ANY DEVIATIONS WILL BE CAUSE FOR REJECTION.					
FRAC. DIM. $\pm$		REMOVE ALL BURRS AND SHARP EDGES					
ANGULAR DIM. $\pm$							

1	REQ. PER UNIT	PMO-3	PROJECT NO.	ASS'Y. NO.	DATE
		MODEL			12-28-56
USED ON					

REQ. ITEM	PART NO.	DESCRIPTION	SYMBOL
	.064	THE TECHNICAL MATERIEL CORP.	
	STOCK SIZE	MAMARONECK, NEW YORK	
	ALUMINUM (SEE NOTE)	REAR COVER, CABINET	
	MATERIAL	MODEL PMO-3	
	5052-H32	<i>Handwritten initials</i>	<i>Handwritten initials</i>
	TYPE & TEMPER	HEAT TREAT. SPEC.	DRAWN
	SEE NOTE		CHECKED
	FINISH & SPEC. NO.	ELEC. DES. APP.	MECH. DES. APP.
			MS-995 B