

REVISIONS						
ZONE	LTR	DESCRIPTION	DATE	E.M.N.NO	DRAFT	CHKD APPD
	0	ORIGINAL RELEASE	3-5-81		898	

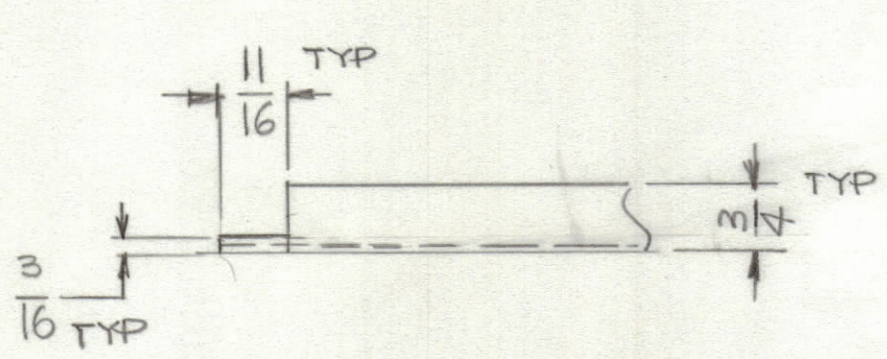

MACHINE CORNERS AFTER BENDING

MARKING TMC P/NO. 1/8 HIGH GOTHIC W/LATEST REVISION LETTER ON REAR OF PANEL

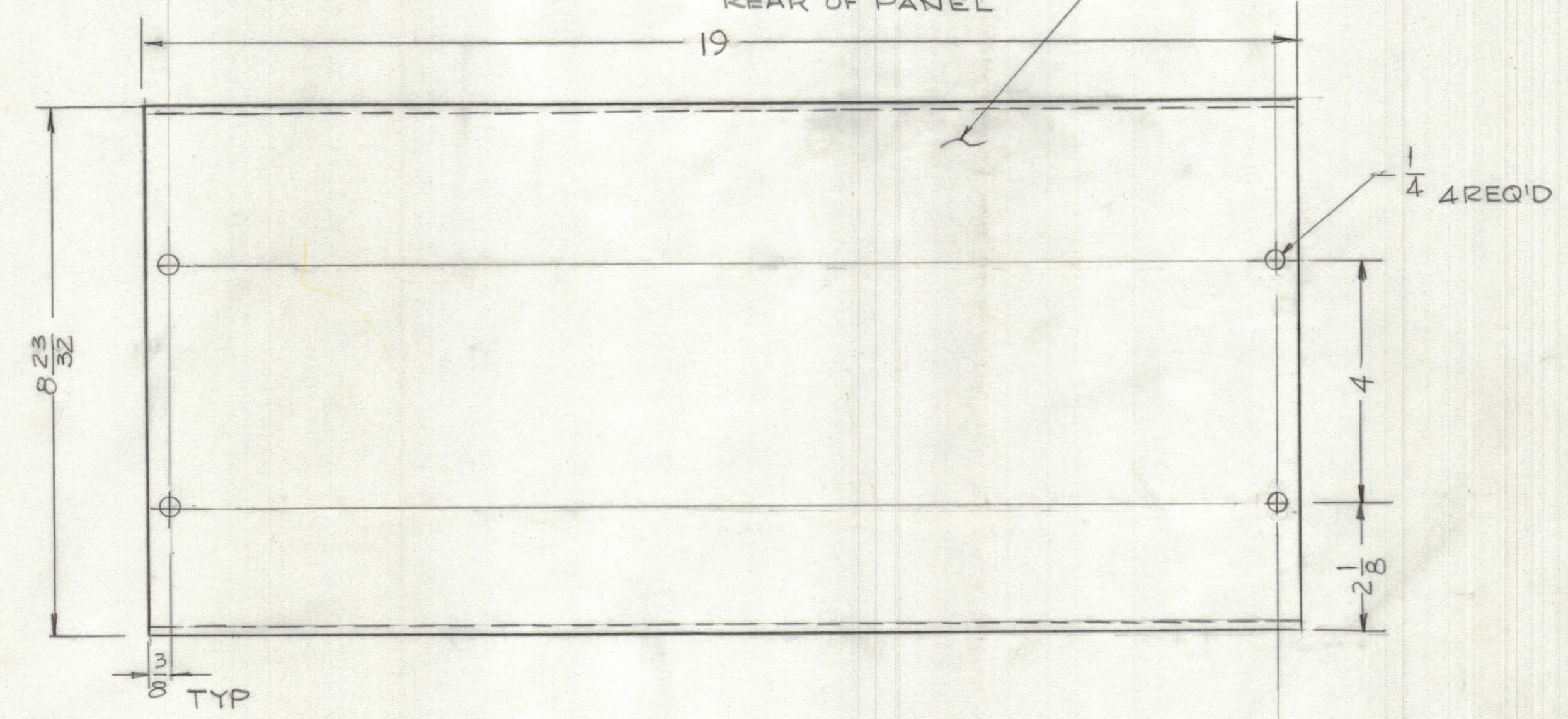

**MACHINING:**

- MILL ALL EDGES.
- Holes must be drilled, unless otherwise specified.
- LATERAL BOW OF PANEL MUST BE KEPT TO .031 TOLERANCE.
- PANEL MUST BE FREE OF ALL MACHINING MARKS, GOUGES AND SCRATCHES. IF NECESSARY, SAND FRONT OF PANEL WITH NO. 120 GRIT SANDPAPER.

**FINISH NOTES:**

- S404 - IRIDITE 14-2 AL-COAT.
- S114 - ZINC CHROMATE PRIMER
- S520 TEX. VINYL

FRONT AND EDGES ONLY

QTY. REQ.	ITEM	PART NO.	DESCRIPTION	SYMBOL
LIST OF MATERIAL				
UNLESS OTHERWISE SPECIFIED DIMENSIONS ARE IN INCHES AND INCLUDE CHEMICALLY APPLIED OR PLATED FINISHES			<b>THE TECHNICAL MATERIEL CORP.</b> MAMARONECK, NEW YORK	
TOLERANCES ON			COVER, PANEL CONTROL	
DECIMALS	FRACTIONS	FINAL APPROVAL	DATE	
.X ± .05	± 1/64	MECH. DES.	DATE	
.XX ± .01	ANGLES	ELECT. DES.	DATE	
.XXX ± .005	± 0° -30'	CHECKED	DATE	
		DRAWN	DATE	
		G.D.L.	10-28-80	
MATERIAL .081 THK ALUM-5052-H32			SIZE	CODE IDENT. NO.
FINISH SEE NOTE			C	82679
			DWG NO.	MS 7057
			SCALE	1/2
			SHEET	OF

QTY / UNIT	MODEL USED ON	ASS'Y NO.
APPLICATION		
CODE		
NOTICE TO PERSONS RECEIVING THIS DRAWING		
<small>THE TECHNICAL MATERIEL CORPORATION claims proprietary right in the material disclosed hereon. This drawing is issued in confidence for engineering information only and may not be reproduced or used to manufacture anything shown hereon without permission from THE TECHNICAL MATERIEL CORPORATION to the user. This drawing is loaned for mutual assistance and is subject to recall at any time.</small>		