

REVISIONS	DATE	APPROVED
EMANNO DRAFT CHKD ZONE LTR		
21711 604	8-27-79	
REORDERED NO CHANGE DWG. LOST	8-27-79	

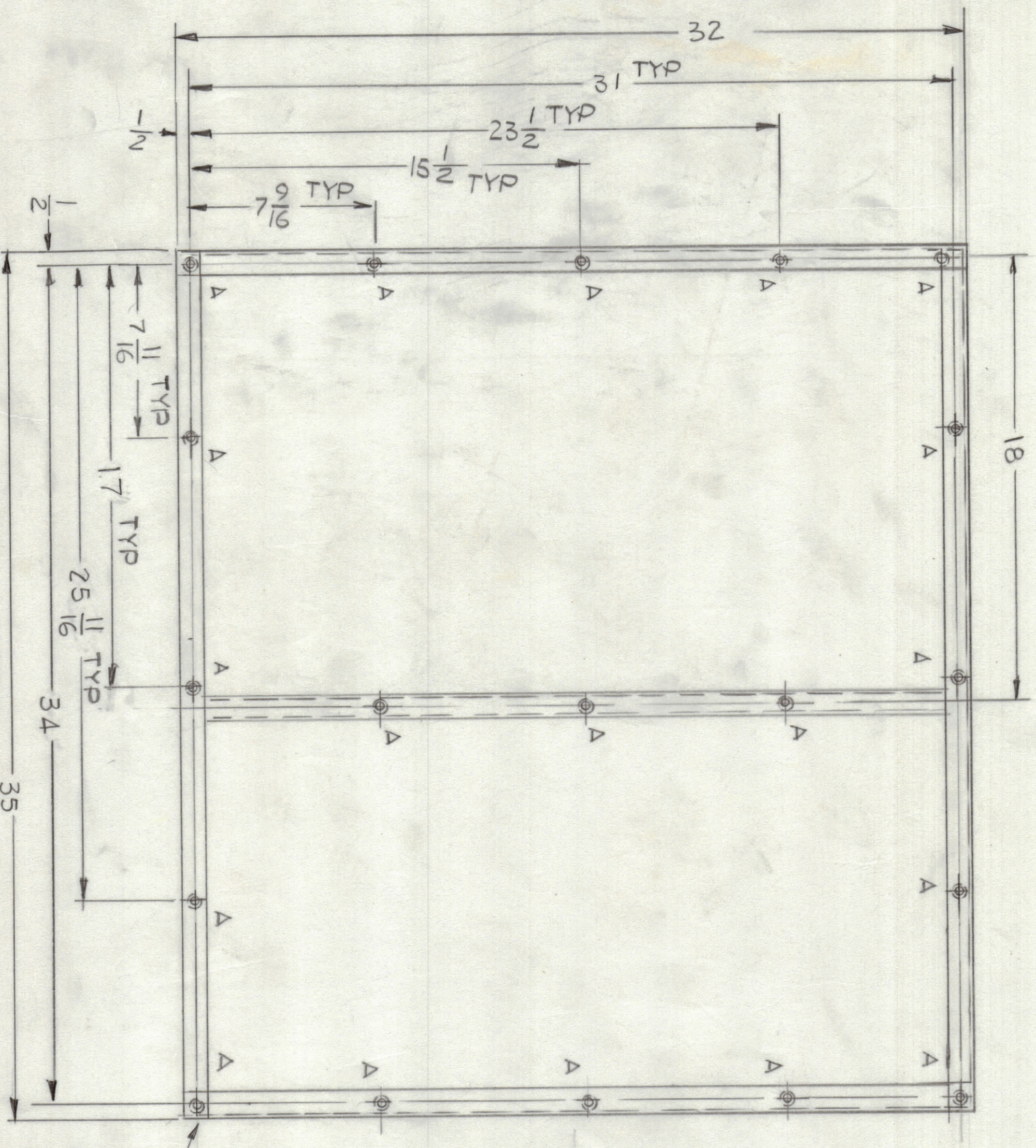
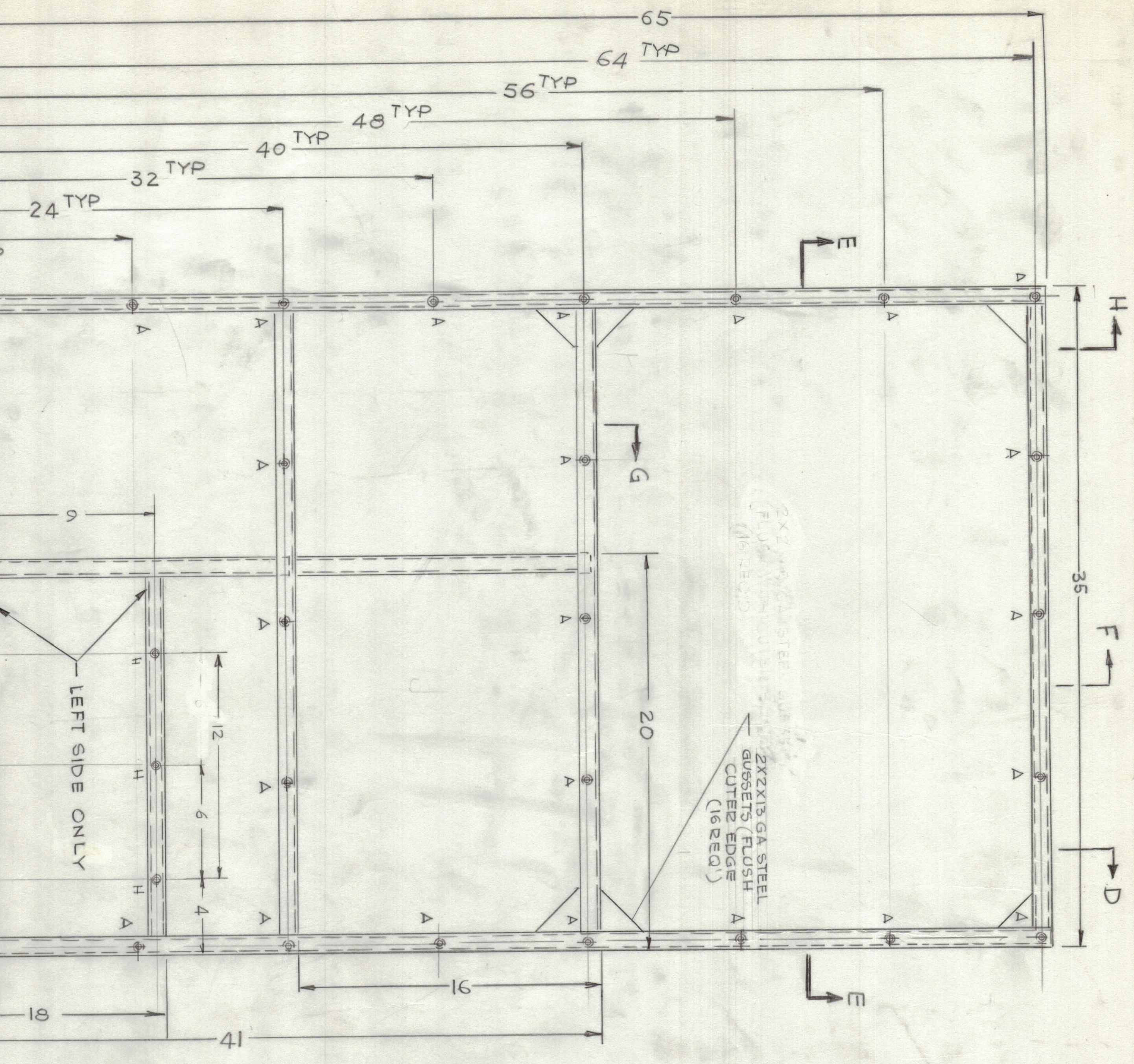

LEFT SIDE
OPPOSITE SIDE SAME "A" HOLES

TOP VIEW

FRONT

1X1 X12 GA.
STEEL PLATE
4 REQ.

2X2 X13 GA STEEL
GUSSETS (FLUSH
CUTTER EDGE
(16 REQ))

QTY. ITEM		PART NO.		SYMBOL	
LIST OF MATERIAL					
THE TECHNICAL MATERIEL CORP.					
MAMARONECK, NEW YORK					
ELECT. DES.		DATE		DATE	
CHECKED		DATE		DATE	
DRAWN		DATE		DATE	
G.D.L.		4-17-78			
MATERIAL		SEE SH. 1		FINISH	
SEE SH. 1				SEE SH. 1	
TOLERANCES ON		FRACTIONS		DECIMALS	
UNLESS OTHERWISE SPECIFIED		± 1/64		± .05	
DIMENSIONS ARE IN INCHES		± 1/64		± .05	
AND INCLUDE CHEMICALLY APPLIED		± 1/64		± .05	
OR PLATED FINISHES		± 1/64		± .05	
QTY / UNIT		MODEL USED ON		ASSY. NO.	
BCT-10KA		BCT-10KA			
APPLICATION		CODE			
SCALE		SIZE (CODE IDENT NO.) DWG. NO.		ISSUE	
D		82679 MSS116		A	
SHEET 3 OF 7					

NOTICE TO PERSONS RECEIVING THIS DRAWING
THE TECHNICAL MATERIEL CORPORATION claims proprietary right in the material disclosed herein. This drawing is issued in confidence and without permission from THE TECHNICAL MATERIEL CORPORATION to the user. This drawing is issued for mutual assistance and is subject to recall at any time.

8 7 6 5 4 3 2 1

A B C D