

IF IT IS FOUND DESIRABLE TO CHANGE ANY TOLERANCE OR OTHER DETAIL SPECIFIED ON THIS DRAWING NOTIFY THE PURCHASER PROMPTLY.

MAXIMUM ALLOWABLE TOLERANCES HAVE BEEN DETERMINED AND DEVIATIONS WILL BE CAUSE FOR REJECTION. REMOVE ALL BURRS AND SHARP EDGES

MS-547 C

A -  $\frac{1}{4}$  (.250) DIA. 4 HOLES REQ.  
 B -  $1\frac{1}{32}$  (.531) DIA. 1 " "

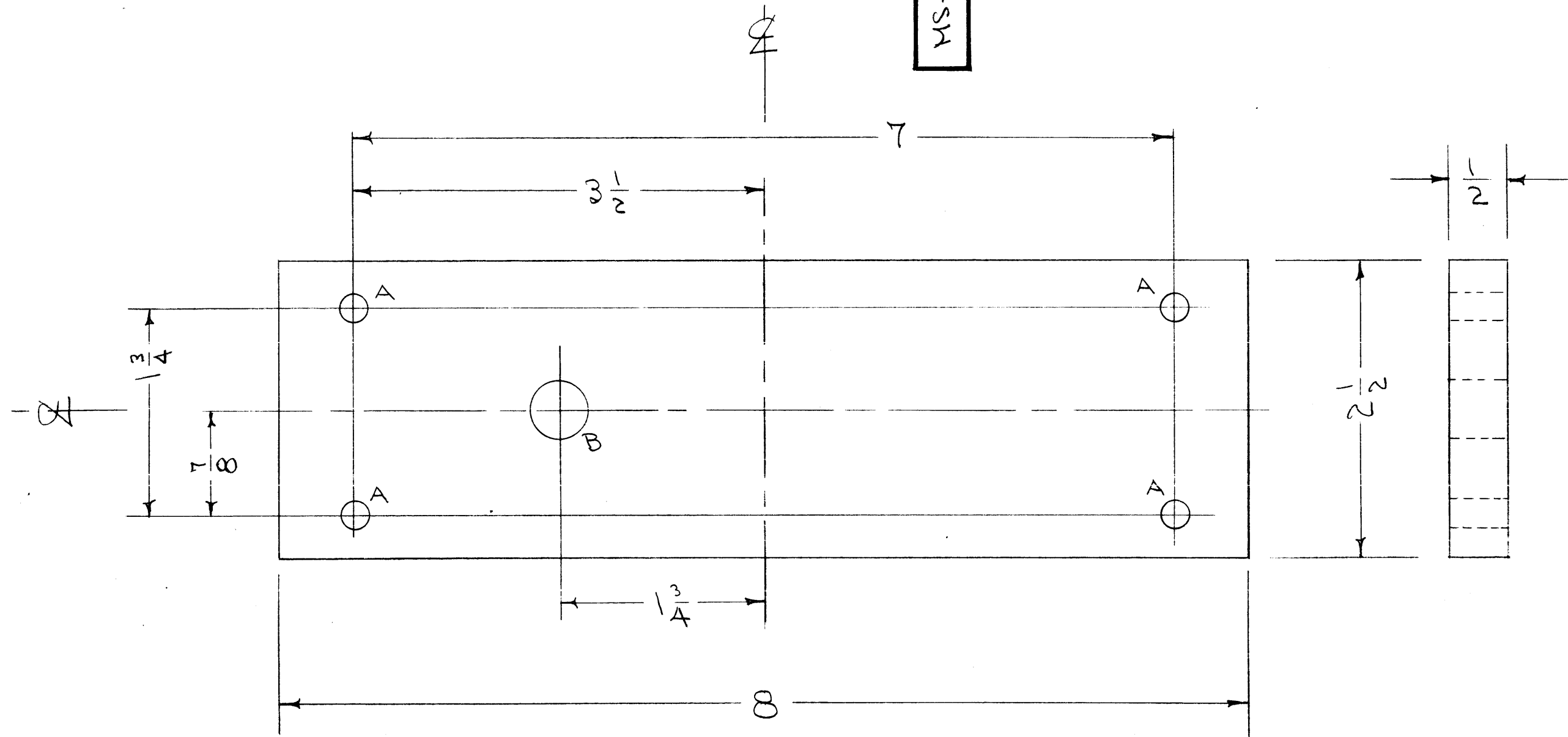

**NOTICE TO PERSONS RECEIVING THIS DRAWING**  
 THE TECHNICAL MATERIEL CORPORATION claims proprietary right in the material disclosed hereon. This drawing is issued in confidence for engineering information only and may not be reproduced or used to manufacture anything shown hereon without permission from THE TECHNICAL MATERIEL CORPORATION to the user. This drawing is loaned for mutual assistance and is subject to recall at any time.  
 Property of:  
 THE TECHNICAL MATERIEL CORPORATION  
 MAMARONECK, NEW YORK

C	1	8 WAS 8 1/4	5/27/57	3	FC: [Signature]	[Signature]	[Signature]
B	1	1 1/32 D WAS 1/2 D	6/13/56	2	[Signature]	[Signature]	[Signature]
A	1	MATERIAL WAS MELAMINE	6/18/55	1	[Signature]	[Signature]	[Signature]
ISSUE	ITEM	CHANGED FROM	DATE	CN. NO.	DRAFTS	CHECKER	ENG. APP.
					1	VRA-2A	2-28-56
					1	VRA-1	7-27-54
					1	VRA-2	7-27-54

REQ. PER UNIT	MODEL	PROJECT NO.	ASS'Y. NO.	DATE

REQ. ITEM	PART NO.	DESCRIPTION	SYMBOL
		1/2 THICK	
		STOCK SIZE	
		NATURAL GRADE NYLON LAMITEX	
		MATERIAL	
		WEIGHT PER PC.	
		TYPE & TEMPER	
		HEAT TREAT. SPEC.	
		FINISH & SPEC. NO.	
		THE TECHNICAL MATERIEL CORP., MAMARONECK, NEW YORK	
		PLATE, MAST SUPPORT	
		YRA	
		C.O.D. 7-27-54	
		DRAWN	
		ELEC. DES. APP.	
		MECH. DES. APP.	
		CHECKED	
		FINAL APPROVAL	
		MS-547	C