

Legend

Letter	Hole Description	Quantity	Remarks
A	See Chart 6-31	26	
B	" " " 3-48	44	
C	.120 Clearance Hole	48	
D	.156 Clearance Hole	13	
EE	See Detail	22	Max. Dim. 2.120
F	SEE DETAIL	8	

Countersink Chart

Letter	Screw Type	X	Y	Remarks
B	3-48 FHS	.024	3-48 CL-4	Drill + Tap
A	6-32 FHS	.084	1-94	CLEARANCE
EE	10-32 FHS	.400	.196	CLEARANCE

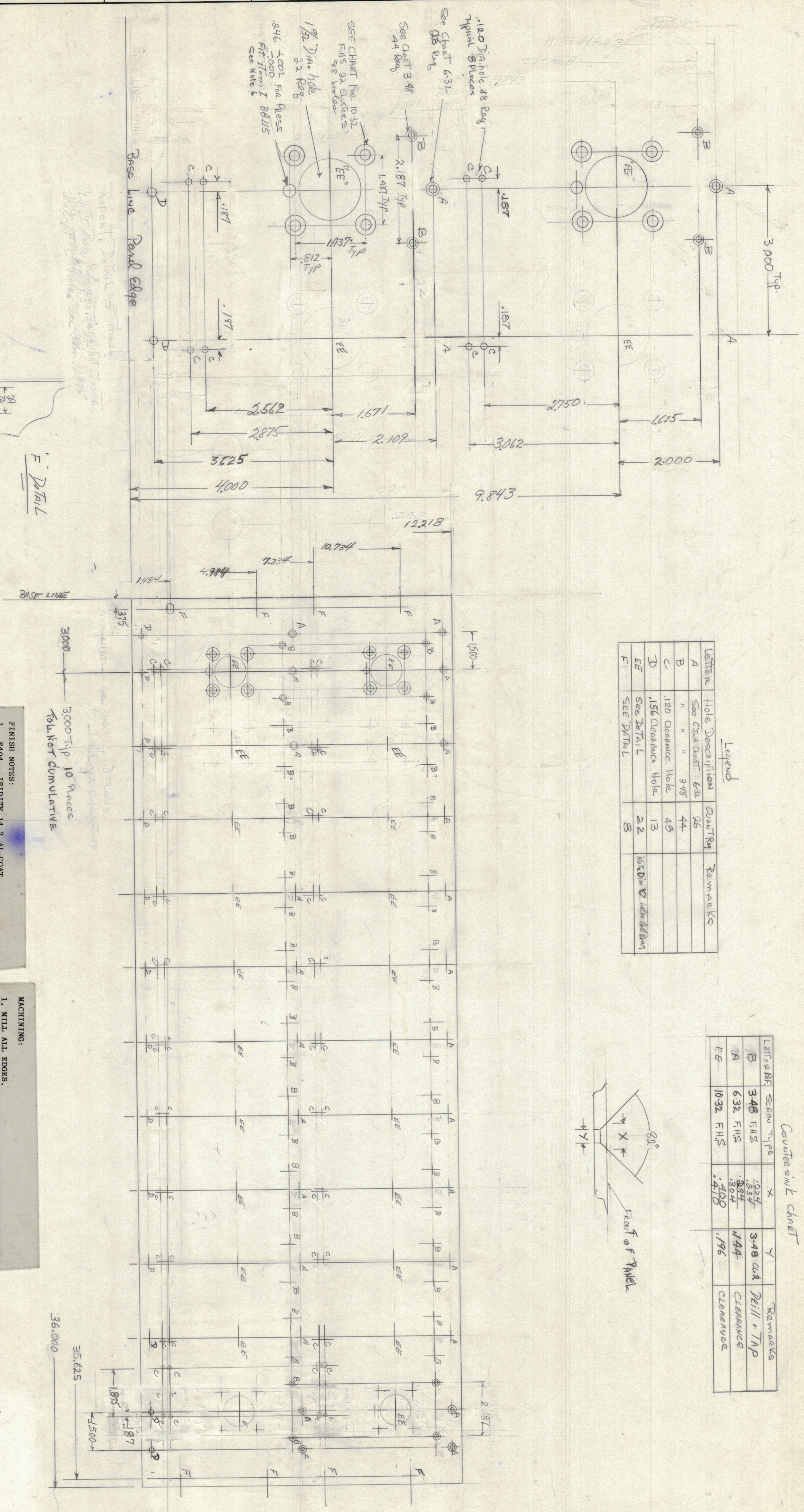
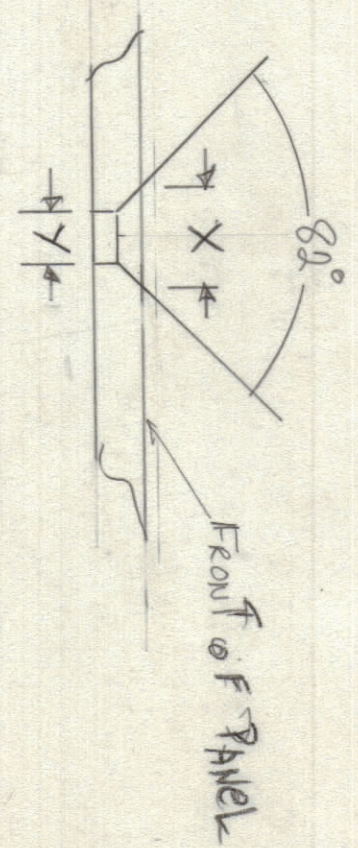

FINISH NOTES:

- S404 - IRIDITE 14-2 AL-COAT, FRONT AND
- S114 - ZINC CHROMATE PRIMER, EDGES ONLY
- S115 - SMOOTH GRAY ENAMEL OR PRIME AND PAINT PER CUSTOMER'S SPECIFICATIONS.

MACHINING:

- MILL ALL EDGES.
- HOLES MUST BE DRILLED, UNLESS OTHERWISE SPECIFIED.
- LATERAL BOW OF PANEL MUST BE KEPT TO .031 TOLERANCE.
- PANEL MUST BE FREE OF ALL MACHINING MARKS, GOUGES AND SCRATCHES. IF NECESSARY, SAND FRONT OF PANEL WITH NO. 120 GRIT SANDPAPER.
- METAL STAMP TWO PART NO. 1/8 HIGH GOTHIC ON REAR OF PANEL.
- PRESS FIT AFTER PAINT DRY!

Repeat Detail for Front Panel
Repeat Detail for Back Panel
Repeat Detail for Side Panel
Repeat Detail for Bottom Panel

NOTES

1. See Notes

2. See Notes

3. See Notes

4. See Notes

5. See Notes

6. See Notes

7. See Notes

8. See Notes

9. See Notes

10. See Notes

11. See Notes

82	1	BB 115	BEHAWIG OLITE	
MATERIAL				
ALUM. 3/16 - 2024 T3				
TITLE				
Panel Front, Machining				
MATERIAL				
MAMARONECK, NEW YORK				
DRAWN				
DATE				
5/26/68				
CHECKED				
DATE				
5/26/68				
ELECT. DES.				
DATE				
5/26/68				
MECH. DES.				
DATE				
5/26/68				
APP. DES.				
DATE				
5/26/68				
REVISIONS				
NO.				
1				
DATE				
5/26/68				
BY				
MS 4969				
CHECKED				
DATE				
5/26/68				
APPROVED				
DATE				
5/26/68				
BY				
MS 4969				
CHECKED				
DATE				
5/26/68				
APPROVED				
DATE				
5/26/68				
BY				
MS 4969				