

REVISIONS					
ZONE	SYM	DESCRIPTION	DATE	E.M.N. NO.	APPD
	Ø	ORIGINAL RELEASE FOR PRODUCTION	4/16/66		Jc Jb

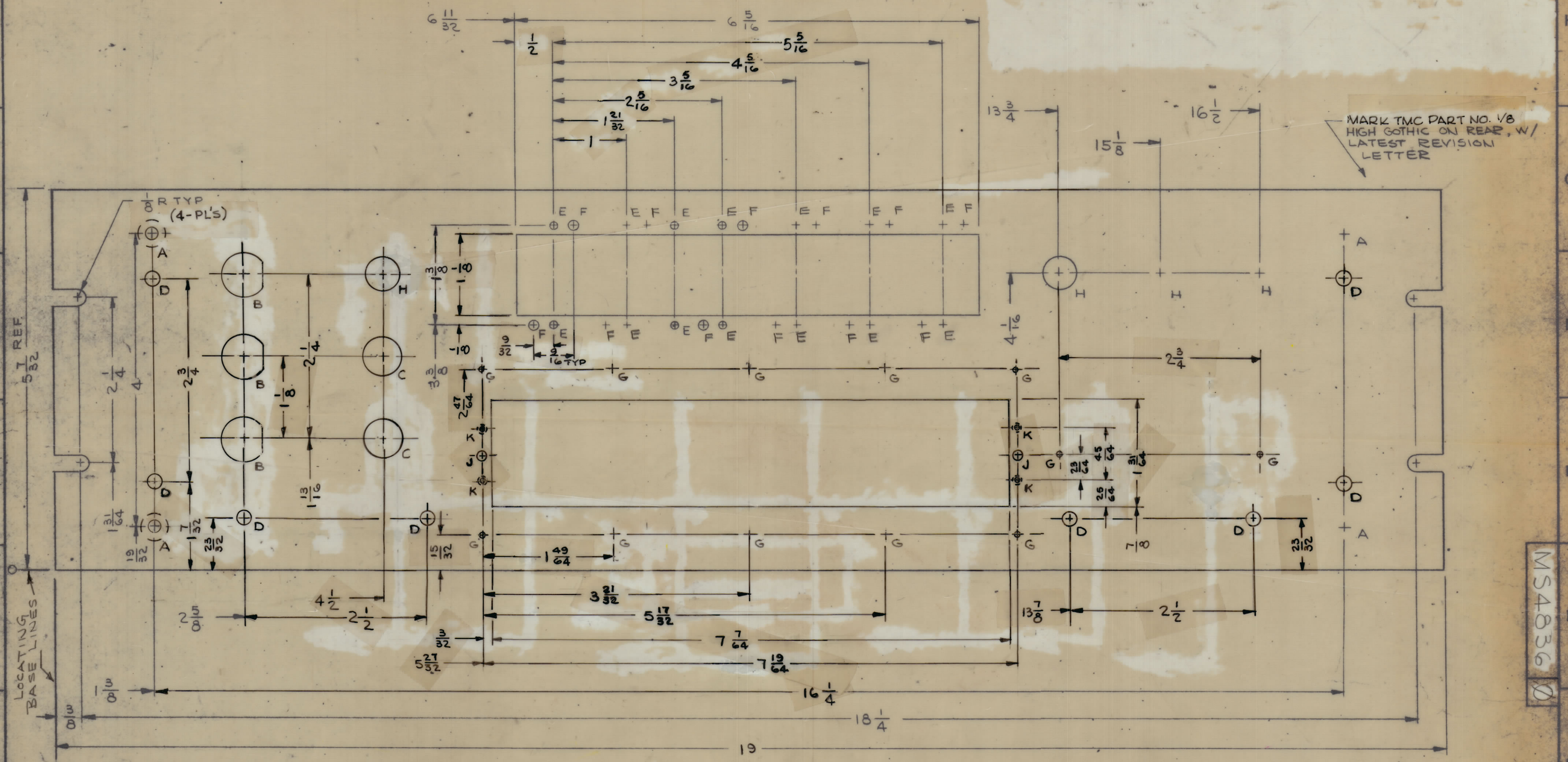

FRONT OF PANEL SHOWN

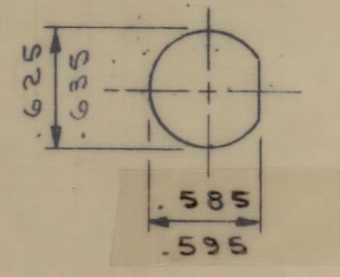

DETAIL-B-

HOLE LEGEND		
HOLE	DESCRIPTION	REQ'D
A	.1196 DIA & C'SINK 82° X .390 DIA (ON REAR)	4
B	SEE DETAIL	5
C	15/32 DIA	2
D	13/64 DIA	8
E	9/64 DIA	14
F	5/32 DIA	12
G	NO. 48 (.0760) DRILL	12
H	13/32	4
J	1/8 DIA	2
K	NO. 43 (.0850) DRILL & TAP NO. 4-40 NC-2B TH'D	4

**MACHINING:**

- MILL ALL EDGES.
- HOLES MUST BE DRILLED, UNLESS OTHERWISE SPECIFIED.
- LATERAL BOW OF PANEL MUST BE KEPT TO .031 TOLERANCE.
- PANEL MUST BE FREE OF ALL MACHINING MARKS, GOUGES AND SCRATCHES. IF NECESSARY, SAND FRONT OF PANEL WITH NO. 120 GRIT SANDPAPER.

**FINISH NOTES:**

- S404 - IRIDITE 14-2 AL-COAT.
- S114 - ZINC CHROMATE PRIMER } FRONT AND
- S115 - SMOOTH GRAY ENAMEL } EDGES ONLY

NOTES

RTIH-1

Q'TY/UNIT	MODEL USED OR CODE	ASSY. NO.
SCALE		
1:1		

THE CONTENTS OF THIS DRAWING ARE THE EXCLUSIVE PROPERTY OF THE TECHNICAL MATERIEL CORP. ITS UNAUTHORIZED USE OR REPRODUCTION IN WHOLE OR IN PART IS STRICTLY FORBIDDEN.

REF. LD 2036

REQ'D.	ITEM	PART NUMBER	DESCRIPTION	SYMBOL
	F. E. EATON		LIST OF MATERIAL	
MATERIAL		THE TECHNICAL MATERIEL CORP. MAMARONECK, NEW YORK		
3/16 THK ALUMINUM 2024-T3		PANEL, FRONT		
FINISH		TITLE		
SEE NOTES		PANEL, FRONT		
UNLESS OTHERWISE SPECIFIED DIMENSIONS ARE IN INCHES AND INCLUDE CHEMICALLY APPLIED OR PLATED FINISHES	DRAWN	DATE	FINAL APPROVAL	DATE
	J. LESHINSKI	11/5/65	F. E. Eaton	4/18/66
DECIMALS X ± .05 .XX ± .01 .XXX ± .008	CHECKED	DATE		
	Jc	4-11-66		
FRACTIONS ± 1/64 ANGLES ± 0° 30'	ELECTY. DES.	DATE		
	W. Brans	4/18/66		
TOLERANCES	MECH. DES.	DATE		
	W. Brans	4/18/66		
		SHEET		REV. LTR.
		MS4836		

MS4836