

REQ. PER UNIT	USED ON			MS-3675 ○
	MODEL	ASS'Y. NO.	DATE	
1	GPT-200K (AT-105)	A-2765	3-16-64	

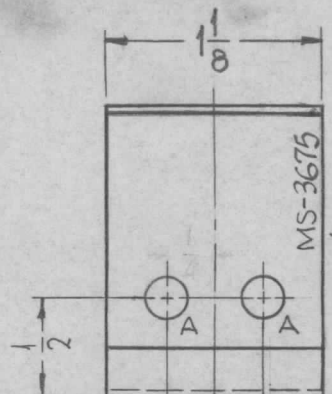

METAL STAMP TMC PART NO. 1/8 HIGH GOTHIC.

HOLES:
 A~ 3/16 DIA. (2REQ.)
 B~ 1/4 DIA. (1REQ.)
 C~ 11/32 DIA. (1REQ.)
 D~ SEE DETAIL

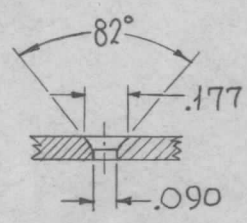
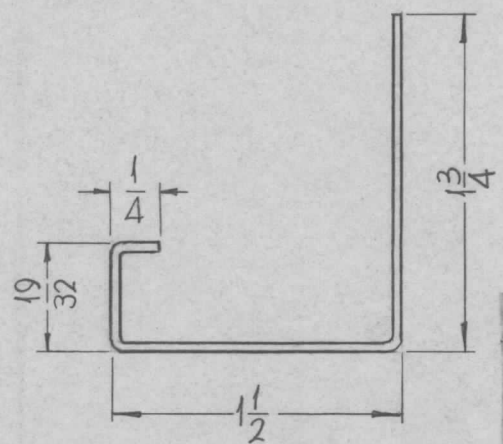
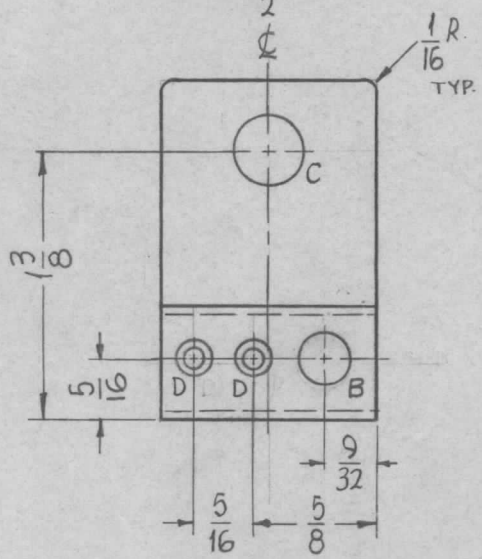

D-DETAIL (2REQ.)

- UNLESS OTHERWISE SPECIFIED:
1. USE MATERIAL THICKNESS FOR MAXIMUM RADIUS ON ALL BENDS.
 2. ALL ANGULAR BENDS 90°.
 3. REMOVE ALL BURRS AND SHARP EDGES.

REF: LD-1452

							REQ. ITEM	PART NO.	F. BUDETTI	DESCRIPTION	SYMBOL	
							.062 THICK		THE TECHNICAL MATERIEL CORP.			
							STOCK SIZE		MAMARONECK. NEW YORK			
							ALUMINUM		BRACKET, CONNECTOR MTG.			
SYM	DESCRIPTION	DATE	CH. NO.	DRAFTS	CHECKER	ENG. APP.	MATERIAL					
UNLESS OTHERWISE SPECIFIED DIMENSIONS ARE IN INCHES AND INCLUDE CHEMICALLY APPLIED OR PLATED FINISHES		SCALE	1"=1"				5052-H32	SRG	aa	RJC		
							TYPE & TEMPER	HEAT TREAT. SPEC.	DRAWN	CHECKED	FINAL APPROVAL	
DECIMALS .X ± .05 .XX ± .01 .XXX ± .005	TOLERANCES	FRACTIONS ± 1/64 ANGLES ± 0° 30'	CODE	A				S-404 YELLOW IRIDITE			MS-3675 ○	
							FINISH & SPEC. NO.	ELEC. DES. APP.	MECH. DES. APP.			

ORIGINAL RELEASE FOR PRODUCTION 4/27/64