

REQ. PER UNIT	USED ON			MS-3531	O
	MODEL	ASS'Y. NO.	DATE		
1	GPT-200K	AX-395	10-5-63		

HOLES  
A- 5/16 X 1/2 SLOTS  
REQ  
2

METAL STAMP TMC PART NO.  
1/8 HIGH GOTHIC.

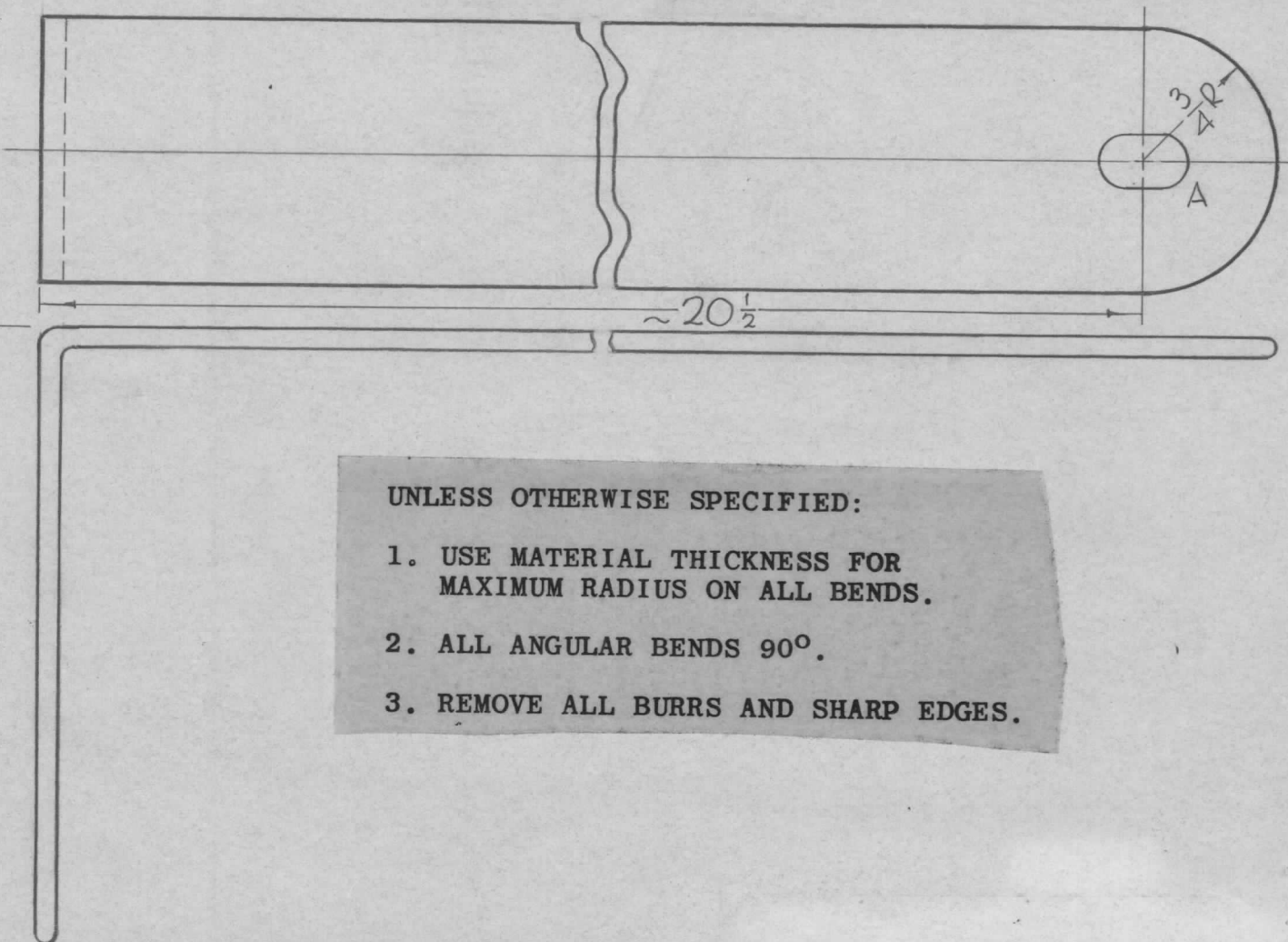
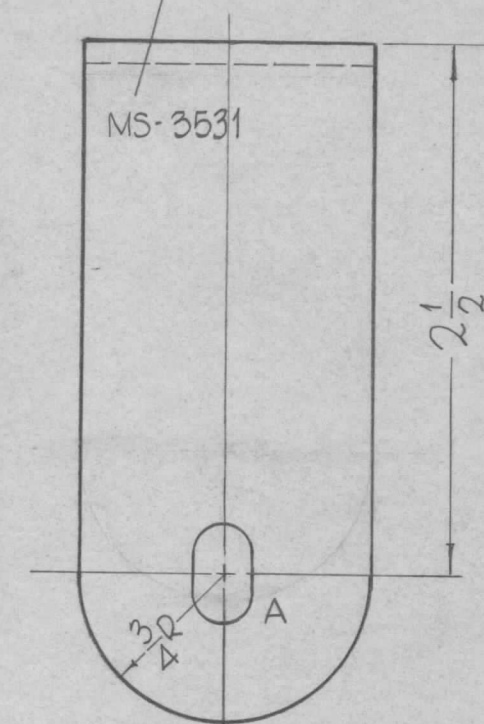

UNLESS OTHERWISE SPECIFIED:

1. USE MATERIAL THICKNESS FOR MAXIMUM RADIUS ON ALL BENDS.
2. ALL ANGULAR BENDS 90°.
3. REMOVE ALL BURRS AND SHARP EDGES.

REQ.	ITEM	PART NO.	F. BUDETTI DESCRIPTION				SYMBOL
		1/8 THICK	THE TECHNICAL MATERIEL CORP.				
		STOCK SIZE	MAMARONECK, NEW YORK				
0	ORIGINAL RELEASE	5.18.64	WB	BRACKET, X			
				H.V. CONNECTION			
UNLESS OTHERWISE SPECIFIED DIMENSIONS ARE IN INCHES AND INCLUDE CHEMICALLY APPLIED OR PLATED FINISHES		SCALE	1" = 1"		5052 H-32	John C. Bielez	RAC
DECIMALS .X ± .05 .XX ± .01 .XXX ± .005	TOLERANCES	FRACTIONS ± 1/64 ANGLES ± 0° 30'	CODE		TYPE & TEMPER S-245-SILVER PLATE, BRIGHT	DRAWN [Signature]	CHECKED 12/64 [Signature]
				FINISH & SPEC. NO.	ELEC. DES. APP.	MECH. DES. APP.	MS-3531 O