

THE CONTENTS OF THIS DRAWING ARE THE EXCLUSIVE PROPERTY OF THE TECHNICAL MATERIEL CORP. ITS UNAUTHORIZED USE OR REPRODUCTION IN WHOLE OR IN PART IS STRICTLY FORBIDDEN.

REQ. PER UNIT	USED ON			MS-2787
	MODEL	ASS'Y. NO.	DATE	
1	TER-18K-A50		12-19-61	
1	TER-18K-C50			

HOLE	DESCRIPTION	REQ.
A	13/64 DIA.	3

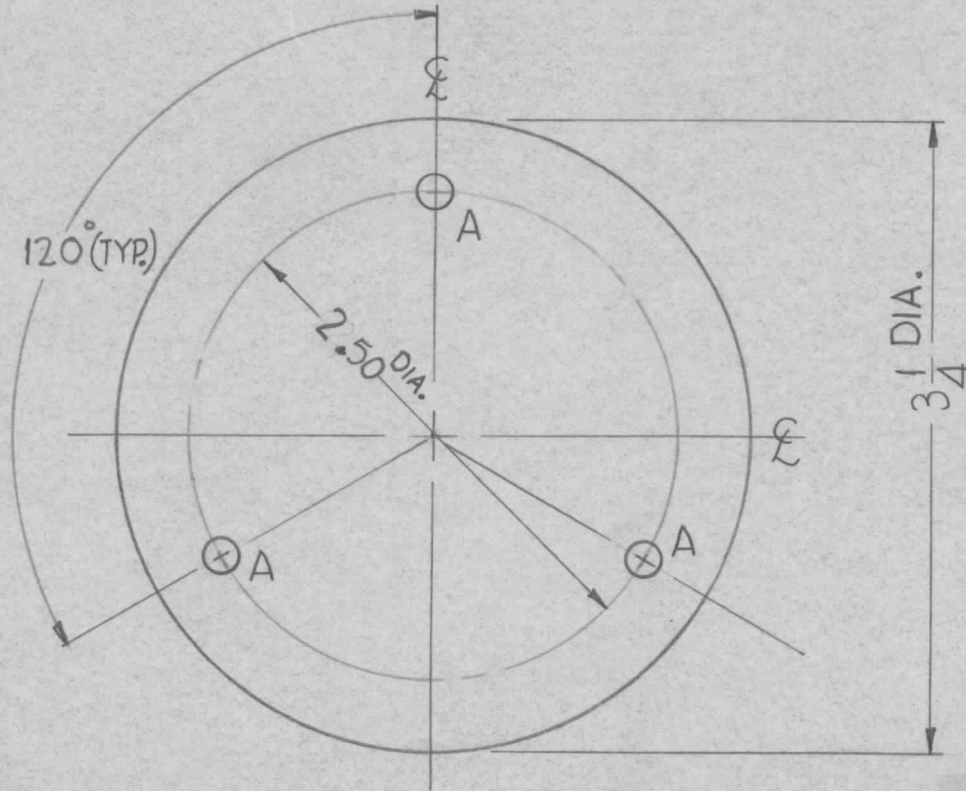

UNLESS OTHERWISE SPECIFIED DIMENSIONS ARE IN INCHES AND INCLUDE CHEMICALLY APPLIED OR PLATED FINISHES	
DECIMALS .X ± .05 .XX ± .01 .XXX ± .005	FRACTIONS ± 1/64 ANGLES ± 0° 30'
TOLERANCES	

CUT HERE
GUARANTEED
2-66

SYM	DESCRIPTION	DATE	CH. NO.	DRAFTS	CHECKER	ENG. APP.	REQ.	ITEM	PART NO.	DESCRIPTION	SYMBOL
									.081	THE TECHNICAL MATERIEL CORP. MAMARONECK, NEW YORK PLATE, COVER (TER-18K)	
									STOCK SIZE		
									ALUMINUM		
									MATERIAL		
							5052-H32			D. J. Mann	
UNLESS OTHERWISE SPECIFIED: DIMENSIONS ARE IN INCHES		SCALE: FULL		TYPE & TEMPER		HEAT TREAT. SPEC.		DRAWN		CHECKED	
TOLERANCES ON		MAXIMUM ALLOWABLE TOLERANCES HAVE BEEN DETERMINED AND ANY DEVIATIONS WILL BE CAUSE FOR REJECTION.		RCAF BLUE S-220				aa		MS-2787	
FRAC. ± 1/64 DEC. ± .005 ANGLES ± 1/2°		REMOVE ALL BURRS AND SHARP EDGES		FINISH & SPEC. NO.		ELEC. DES. APP.		MECH. DES. APP.			