

REQ. PER UNIT	USED ON			MS-2201	G
	MODEL	ASS'Y. NO.	DATE		
6	AX-209	40K	4-22-60		

A  $\phi$  11/64 X 11/32 SLOT 1 REQ.

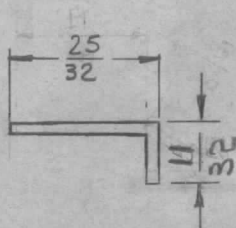
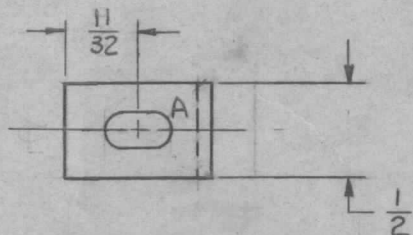

NOTE: THIS PART IS NO LONGER USED

NOTE: NO LONGER USED

REV.	DESCRIPTION	DATE	CH. NO.	DRAFTS	CHECKER	ENG. APP.	REQ.	ITEM	PART NO.	DESCRIPTION	SYMBOL		
E	FINISH ADDED	7/15/64	11210							THE TECHNICAL MATERIEL CORP. MAMARONECK, NEW YORK CLIP, TUBE	G		
D	11/32 DIM. WAS 3/8	7/15/64	11210										
C	25/32 DIM. WAS 5/8	7/15/64	11210										
G	ON FRONT VIEW DIM 11/32 WAS 5/16	7-29-64	11991										
F	MAT. WAS COPPER. NOTE: BURR NOTE DEL.	4/15/64	11210	A.M.									
	ISSUE ITEM	CHANGED FROM	DATE	CH. NO.	DRAFTS	CHECKER	ENG. APP.						
TOLERANCES			SCALE:				TYPE & TEMPER		HEAT TREAT. SPEC.		DRAWN	CHECKED	FINAL APPROVAL
DEC. DIM. $\pm$			MAXIMUM ALLOWABLE TOLERANCES HAVE BEEN DETERMINED AND ANY DEVIATIONS WILL BE CAUSE FOR REJECTION. REMOVE ALL BURRS AND SHARP EDGES				S245 SILVER PLATE		S423 CLEAR IRIDITE				MS-2201
FRAC. DIM. $\pm$ 1/64							FINISH & SPEC. NO.		ELEC. DES. APP		MECH. DES. APP		
ANGULAR DIM. $\pm$													