

REVISIONS							
ZONE	SYM	DESCRIPTION	DATE	E.M.N. NO.	DRAFT	CHKD	APPD
0		ORIGINAL RELEASE FOR PRODUCTION	7.27.64				
A		J480 HOLE SHAPE REVISED	11.13.64	12921			

-BOTTOM-

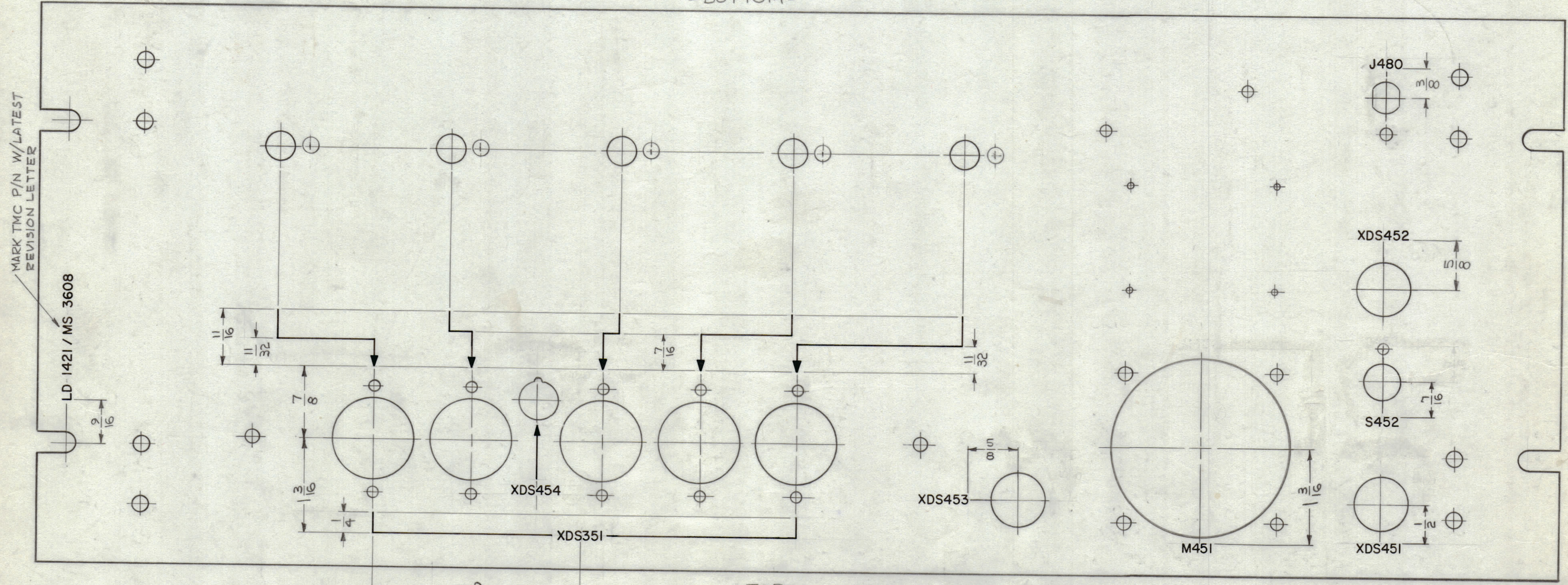

-TOP- REAR OF PANEL AS SHOWN

MARK TMC P/N W/LATEST REVISION LETTER

LD 1421 / MS 3608

- ~ UNLESS OTHERWISE SPECIFIED ~
- 1- MARKING, TO BE 1/8 HIGH, BLACK GOTHIC.
 - 2- MARKING PROCESS: PER TMC SPEC. S-727.
 - 3- ALL LINWORK, .015 WIDTH OF STROKE.
 - 4- ALL ARROWHEADS TO BE BLACK GOTHIC FILLED. SEE DETAIL.

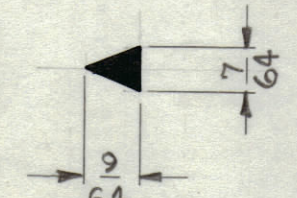
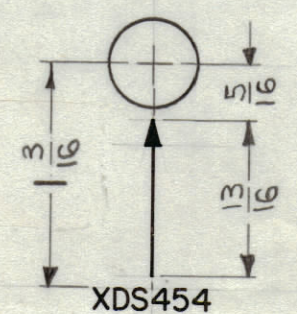

NOTES

1	LFS-1	
Q'TY/UNIT	MODEL USED ON	ASS'Y. NO.
SCALE 1:1	CODE A	
THE CONTENTS OF THIS DRAWING ARE THE EXCLUSIVE PROPERTY OF THE TECHNICAL MATERIEL CORP. ITS UNAUTHORIZED USE OR REPRODUCTION IN WHOLE OR IN PART IS STRICTLY FORBIDDEN.		

REF: MS-3608

REQ'D.	ITEM	PART NUMBER	DESCRIPTION	SYMBOL
M. GELLMAN LIST OF MATERIAL				
MATERIAL		THE TECHNICAL MATERIEL CORP. MAMARONECK, NEW YORK		
FINISH		TITLE MARKING, FRONT PANEL MARKING, PER TMC SPEC. S-727		
UNLESS OTHERWISE SPECIFIED DIMENSIONS ARE IN INCHES AND INCLUDE CHEMICALLY APPLIED OR PLATED FINISHES		DRAWN G. Jansen	DATE 8-24-63	FINAL APPROVAL RDL
DECIMALS .X ± .05 .XX ± .01 .XXX ± .005		CHECKED M	DATE 7-25-64	DATE
FRACTIONS ± 1/64 ANGLES ± 0° 30'		ELECT. DES. M	DATE 7-25-64	DATE
TOLERANCES		MECH. DES. M	DATE 7-25-64	DATE
LD 1421 A				REV. LTR.
SHEET 2 OF 2				

LD 1421 A