

IF IT IS FOUND DESIRABLE TO CHANGE ANY TOLERANCE OR OTHER DETAIL SPECIFIED ON THIS DRAWING NOTIFY THE PURCHASER PROMPTLY.

MAXIMUM ALLOWABLE TOLERANCES HAVE BEEN DETERMINED AND DEVIATIONS WILL BE CAUSE FOR REJECTION. REMOVE ALL BURRS AND SHARP EDGES

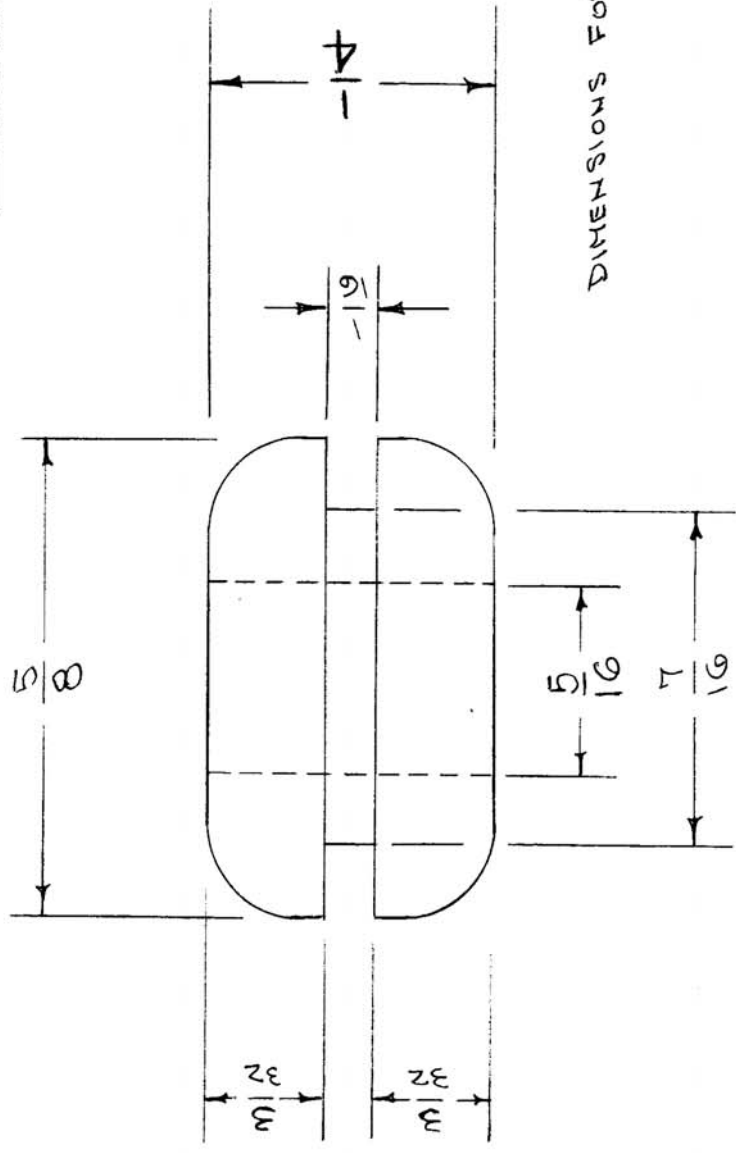

DIMENSIONS FOR REFERENCE ONLY.

REF: THE MILLER RUBBER CO. CAT. NO. GB 2252

REQ. ITEM		PART NO.		DESCRIPTION		SYMBOL	
				THE TECHNICAL MATERIEL CORP.			
STOCK SIZE				MAMARONECK, NEW YORK			
MATERIAL		WEIGHT PER PC.		GROMMET, RUBBER			
TYPE & TEMPER		DRAWN		ELEC. DES. APP.		MECH. DES. APP.	
CDR. 5126155		P.L.K.		G.T.O.		I.D.C.	
CHECKER		HEAT TREAT. SPEC.		CHECKED		FINAL APPROVAL	
FINISH & SPEC. NO.				EX-105		A	

ISSUE ITEM	CHANGED FROM	DATE	CN. NO.	DRAFTS	CHECKER	ENG. APP.
A 1	SUPPLIER WAS THE CAMFIELD RUBBER CO. CAT. NO. 197B - DIM. CHG	9/23/58	1	ONE	ALD	[Signature]

TOLERANCES		SCALE	
DEC. DIM. ±	DRILL, PUNCH, COMMERCIAL STOCK		
FRAC. DIM. ±	SIZES AND MANUFACTURERS		
ANGULAR DIM. ±	TOLERANCES ARE NOT INCLUDED.		