

REQ. PER UNIT
1

USED ON
MODEL
VLRB-1

ABBY. NO.
7/2/64

CZ101 A

GEAR DATA	
PITCH	48
Nº OF TEETH	50
PITCH DIA	1.0416
O. D.	1.0833
PRESS. ANGLE	20°

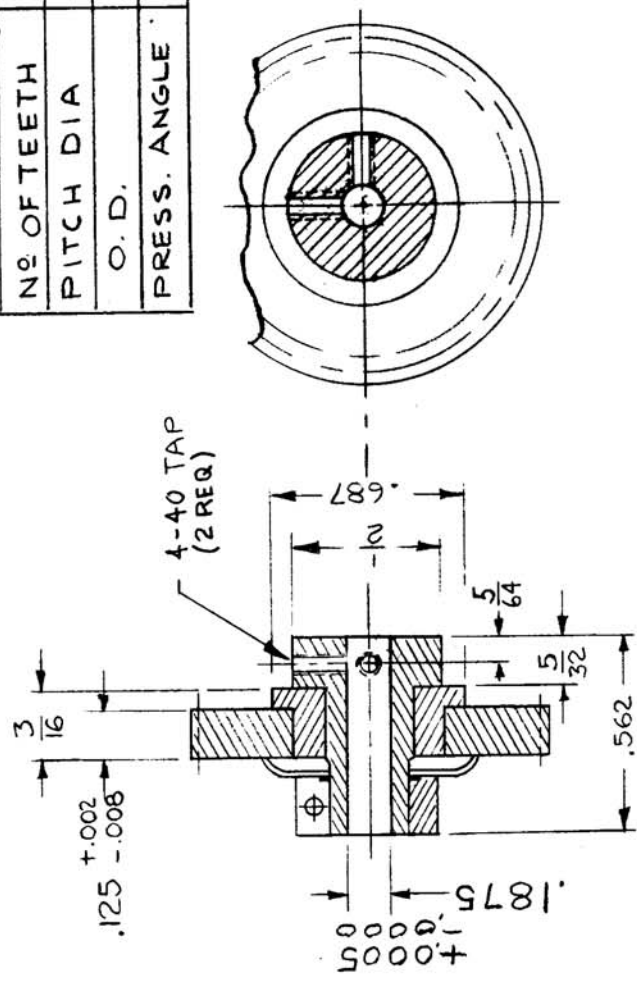

REQ. ITEM	PART NO.	T.KRUY	DESCRIPTION	SYMBOL
1			CLUTCH, SLIP	A
STAINLESS STEEL		THE TECHNICAL MATERIEL CORP. MAMARONECK, NEW YORK		
303		7.2.64	8-28-64	
PASSIVATE		APB	APC	
FINISH & SPEC. NO.		ELEC. DES. APP. MECH. DES. APP.		
NONE		FINAL APPROVAL		
SCALE		CZ101		
DATE		C		
11-25-64		S401-346 (MSC150-50)		
12997		NONE		
9-30-64		CH. NO.		
7/2/64		DATE		
EXPER. RELEASE		DESCRIPTION		
ON PICT. 3/64 DR. PARTWAY "S"		UNLESS OTHERWISE SPECIFIED		
REF: DYNAMIC... DELE.		DIMENSIONS ARE IN INCHES AND INCLUDE		
SIDE VIEW 5/8 DIM. ADD. 4-40 TAP (2 REQ)		CHEMICALLY APPLIED OR PLATED FINISHES		
WAS 2-54 TAP "S401-346 (MSC150-50) ADD.		FRACTIONS		
ORIGINAL RELEASE FOR PRODUCTION		± 1/64		
		ANGLES,		
		± 0° 30'		
		DECIMALS		
		.X ± .05		
		.XX ± .01		
		.XXX ± .005		