

REVISIONS							
ZONE	LTR	DESCRIPTION	DATE	E.M.N.NO	DRAFT	CHKD	APPD
A		SEE SHEET 2					

REAR VIEW

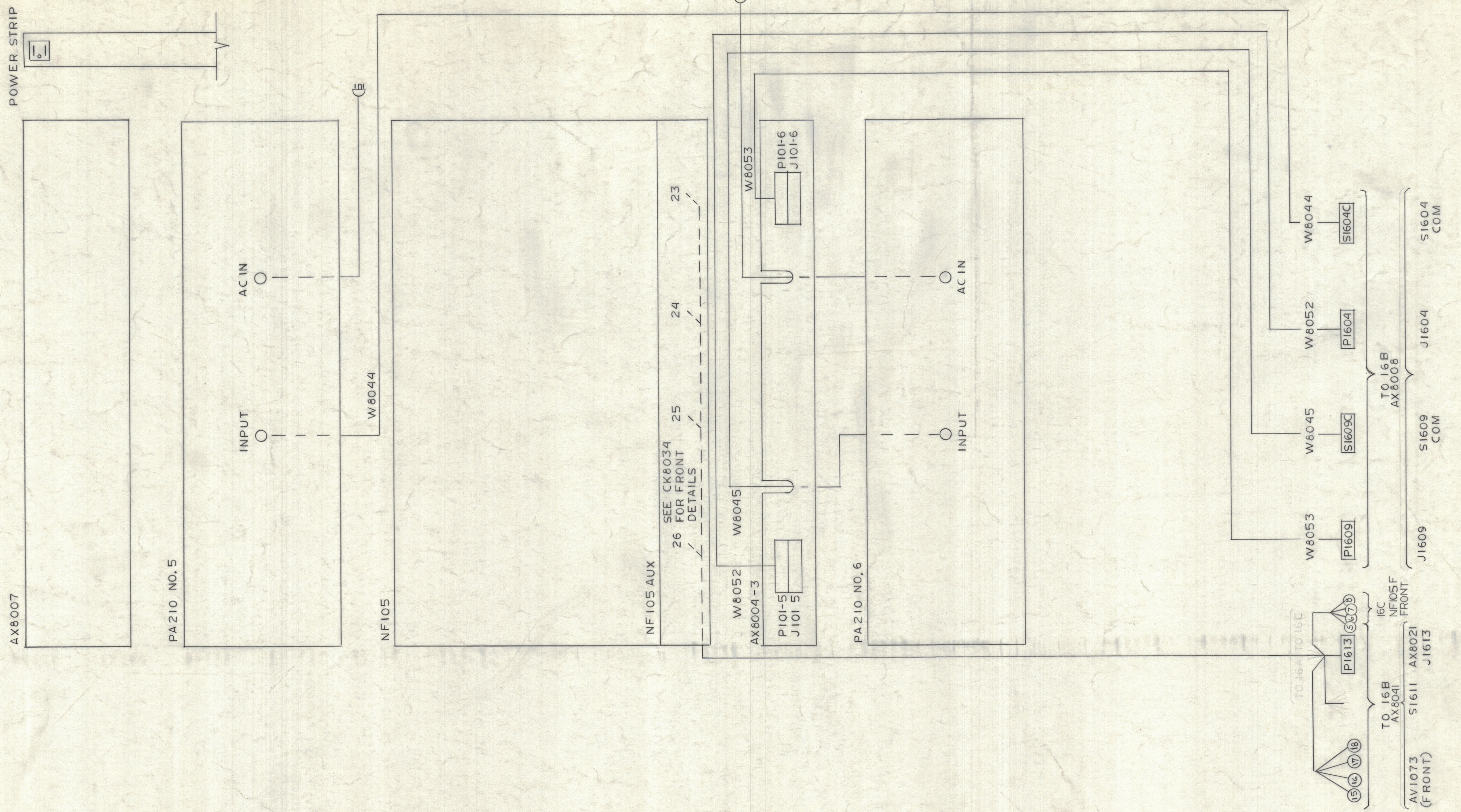

SEE CK8034
26 FOR FRONT
25
24
23
DETAILS

NOTE:
FOR CABLES "W" SERIES
SEE CH800

QTY. REQ.	ITEM	PART NO.	DESCRIPTION	SYMBOL
LIST OF MATERIAL				
THE TECHNICAL MATERIEL CORP. MAMARONECK, NEW YORK				
WIRING DIAGRAM REAR VIEW UNIT 16A				
SIZE	CODE	IDENT. NO.	DWG. NO.	ISSUE
D	82679	CK8121		A
SCALE				SHEET 1 OF 3

UNLESS OTHERWISE SPECIFIED DIMENSIONS ARE IN INCHES AND INCLUDE CHEMICALLY APPLIED OR PLATED FINISHES	FINAL APPROVAL <i>SWM</i>	DATE 7-29-68
	MECH. DES.	DATE
	ELECT. DES.	DATE 7-24-68
	CHECKED <i>SMO</i>	DATE 7-24-68
	DRAWN C.D.DEAN	DATE 6-28-68

TOLERANCES ON	
DECIMALS	FRACTIONS
.X ± .05	± 1/64
.XX ± .01	ANGLES
.XXX ± .005	± 0° - 30'

QTY / UNIT	MODEL USED ON	ASS'Y NO.
APPLICATION		
CODE		
MATERIAL		
FINISH		

NOTICE TO PERSONS RECEIVING THIS DRAWING
THE TECHNICAL MATERIEL CORPORATION claims proprietary right in the material disclosed hereon. This drawing is issued in confidence for engineering information only and may not be reproduced or used to manufacture anything shown hereon without permission from THE TECHNICAL MATERIEL CORPORATION to the user. This drawing is loaned for mutual assistance and is subject to recall at any time.

REAR VIEW

REVISIONS						
ZONE	LTR	DESCRIPTION	DATE	E.M.N.NO	DRAFT	CHKD APPD
1		SUPERSEDES CK8037	7-29		CE	
2		NOTE 1 ADDED	8-15-68		CE	

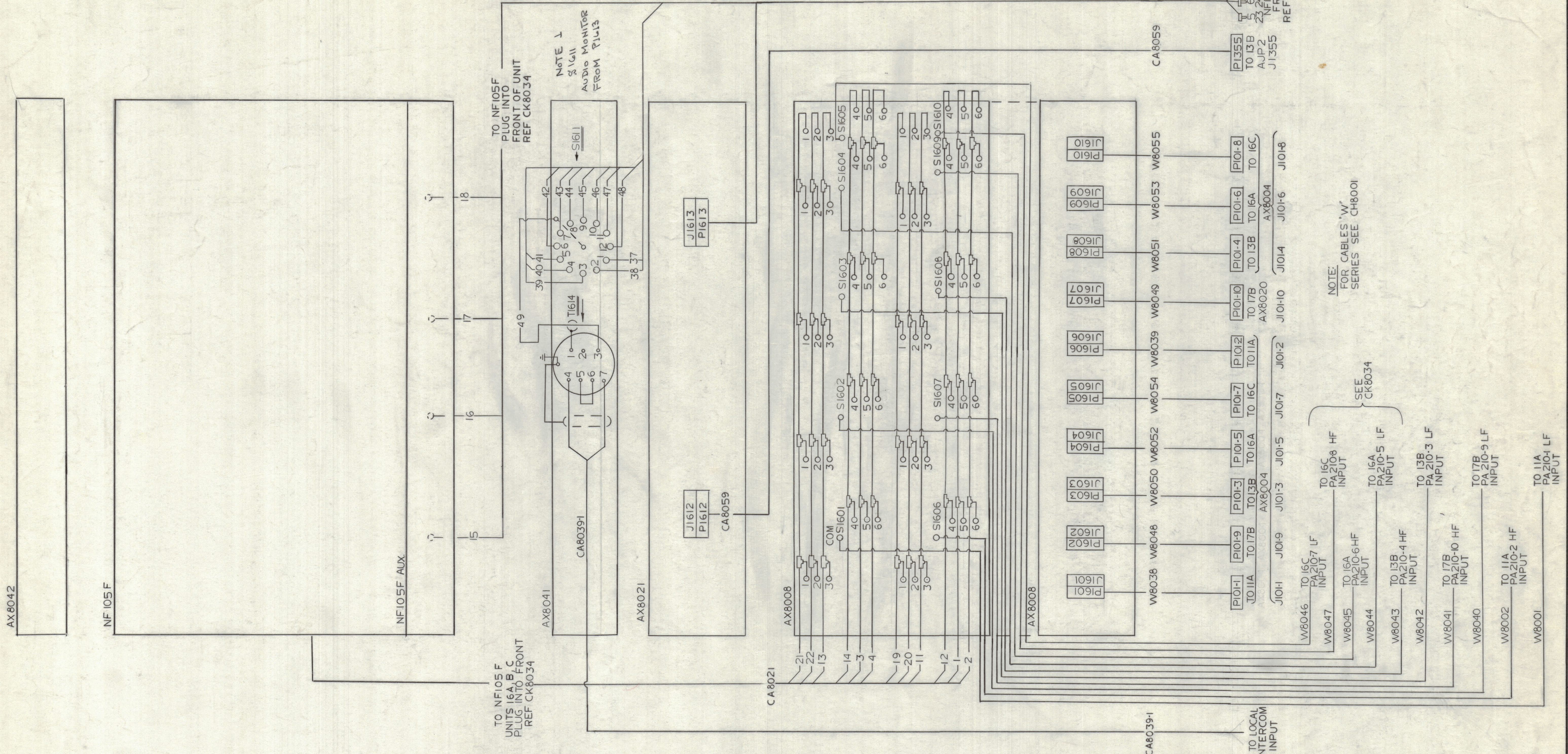
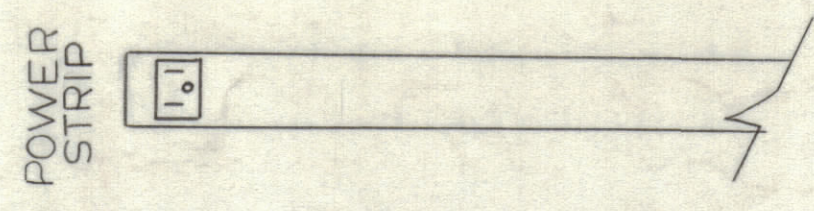

NOTE:
FOR CABLES "W"
SERIES SEE CH8001

SEE
CK8034

QTY. REQ.	ITEM	PART NO.	DESCRIPTION	SYMBOL
			TO 16C PA210-8 HF INPUT	
			TO 16A PA210-5 LF INPUT	
			TO 13B PA210-3 LF INPUT	
			TO 17B PA210-10 HF INPUT	
			TO 11A PA210-2 HF INPUT	
			TO 11A PA210-1 LF INPUT	
			TO 16C PA210-7 LF INPUT	
			TO 16A PA210-6 HF INPUT	
			TO 13B PA210-4 HF INPUT	
			TO 17B PA210-10 HF INPUT	
			TO 11A PA210-2 HF INPUT	
			TO 11A PA210-1 LF INPUT	

UNLESS OTHERWISE SPECIFIED DIMENSIONS ARE IN INCHES AND INCLUDE CHEMICALLY APPLIED OR PLATED FINISHES	FINAL APPROVAL <i>[Signature]</i>	DATE 7-30-68
TOLERANCES ON DECIMALS .X ± .05 .XX ± .01 .XXX ± .005	ELECT. DES. <i>[Signature]</i>	DATE 7-29-68
	CHECKED <i>[Signature]</i>	DATE 7-24-68
	DRAWN <i>[Signature]</i>	DATE 6-26-68

QTY / UNIT	MODEL USED ON	ASS'Y NO.
	APPLICATION	
	CODE	

NOTICE TO PERSONS RECEIVING THIS DRAWING
THE TECHNICAL MATERIEL CORPORATION claims proprietary right in the material disclosed herein. This drawing is issued in confidence for engineering information only and may not be reproduced or used to manufacture anything shown hereon without permission from THE TECHNICAL MATERIEL CORPORATION to the user. This drawing is loaned for mutual assistance and is subject to recall at any time.

LIST OF MATERIAL			
THE TECHNICAL MATERIEL CORP. MAMARONECK, NEW YORK			
WIRING DIAGRAM REAR VIEW UNIT 16B			
SIZE	CODE IDENT.NO.	DWG NO.	ISSUE
D	82679	CK8121	A
SCALE			SHEET 2 OF 3

REVISIONS						
ZONE	LTR	DESCRIPTION	DATE	E.M.N. NO.	DRAFT	CHKD
A		SEE SHEET 2				

REAR VIEW

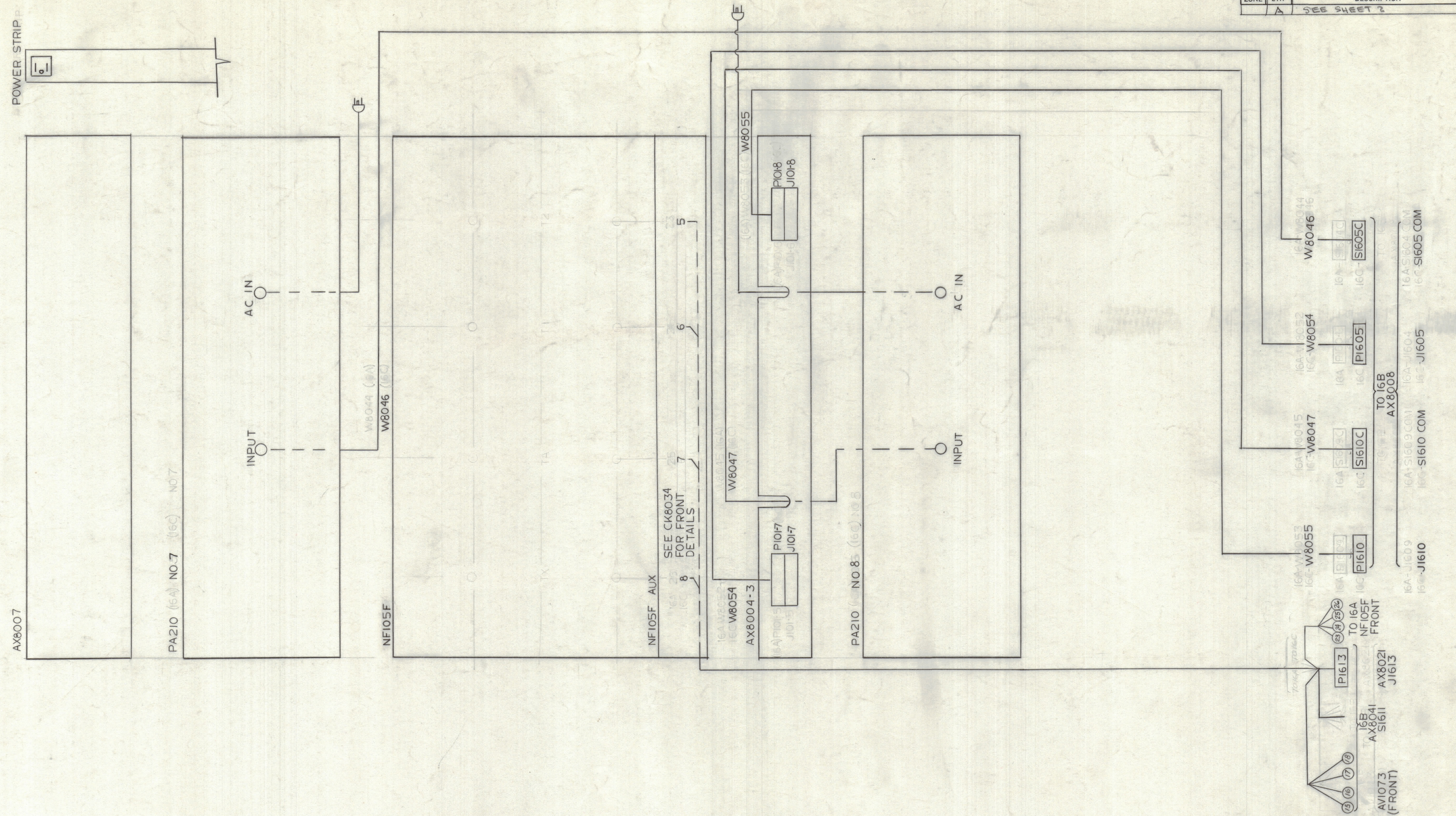

SEE CK8034 FOR FRONT DETAILS

NOTE: FOR CABLES "W" SERIES SEE CH8001

QTY. REQ.	ITEM	PART NO.	DESCRIPTION	SYMBOL
LIST OF MATERIAL				
THE TECHNICAL MATERIEL CORP. MAMARONECK, NEW YORK				
WIRING DIAGRAM REAR VIEW UNIT 16C 16C				
SIZE	CODE	IDENT. NO.	DWG. NO.	ISSUE
D	82679		CK8121	A
SCALE				SHEET 3 OF 3

FINAL APPROVAL	DATE
<i>SJM</i>	7-30-68
MECH. DES.	DATE
ELECT. DES.	DATE
<i>WJ</i>	7-27-68
CHECKED	DATE
<i>SJM</i>	7-24-68
DRAWN	DATE
<i>GB</i>	6-24-68

UNLESS OTHERWISE SPECIFIED DIMENSIONS ARE IN INCHES AND INCLUDE CHEMICALLY APPLIED OR PLATED FINISHES

TOLERANCES ON
 DECIMALS .X ± .05
 .XX ± .01
 .XXX ± .005
 FRACTIONS ± 1/64
 ANGLES ± 0°-30'

QTY / UNIT	MODEL USED ON	ASS'Y. NO.
APPLICATION		
CODE		
NOTICE TO PERSONS RECEIVING THIS DRAWING		
<small>THE TECHNICAL MATERIEL CORPORATION claims proprietary right in the material disclosed hereon. This drawing is issued in confidence for engineering information only and may not be reproduced or used to manufacture anything shown hereon without permission from THE TECHNICAL MATERIEL CORPORATION to the user. This drawing is loaned for mutual assistance and is subject to recall at any time.</small>		
MATERIAL		
FINISH		