

# STANDARD DRAWING

IF IT IS FOUND DESIRABLE TO CHANGE ANY TOLERANCE OR OTHER DETAIL SPECIFIED ON THIS DRAWING NOTIFY THE PURCHASER PROMPTLY.

MAXIMUM ALLOWABLE TOLERANCES HAVE BEEN DETERMINED AND DEVIATIONS WILL BE CAUSE FOR REJECTION. REMOVE ALL BURRS AND SHARP EDGES

BB-106

USED ON  
 PROJECT NO. \_\_\_\_\_  
 MODEL \_\_\_\_\_  
 ASSY. NO. \_\_\_\_\_  
 DATE \_\_\_\_\_

TMC NO.	A		B		C	CAT. NO. GEN'L.
	ACTUAL SIZE	NOM. SIZE	ACTUAL SIZE	NOM. SIZE		
BB-106-1	.255	1/4	.625	5/8	1/16	T400
BB-106-2	.315	5/16	.750	3/4	1/16	
BB-106-3	.390	3/8	.750	3/4	1/32	
BB-106-4	.507	1/2	.750	3/4	1/16	
BB-106-5	.505	1/2	.875	7/8	3/16	
BB-106-6	.510	1/2	1.000	1	1/16	
BB-106-7	.565	9/16	1.250	1 1/4	1/8	
BB-106-8	.628	5/8	1.000	1	1/8	
BB-106-9	.627	5/8	1.187	1 3/16	3/32	
BB-106-10	.765	3/4	1.562	1 9/16	3/32	
BB-106-11	.765	3/4	1.750	1 3/4	1/8	
BB-106-12	.890	7/8	1.500	1 1/2	1/8	
BB-106-13	.890	7/8	2.125	2 1/8	1/8	
BB-106-14	1.003	1	1.504	1 1/2	1/8	
BB-106-15	1.016	1	2.000	2	1/8	
BB-106-16	1.253	1 1/4	1.750	1 3/4	1/8	
BB-106-17	1.510	1 1/2	3.500	3 1/2	3/16	
BB-106-18	1.510	1 1/2	3.000	3	3/16	

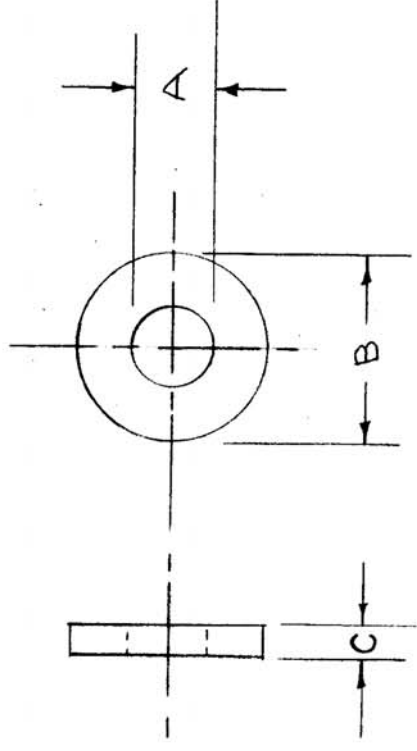

REF: BOSTON GEAR CO. TB-410  
 GEN. MOTORS CORP T-400

REQ. ITEM	PART NO.	DESCRIPTION	SYMBOL
		THE TECHNICAL MATERIEL CORP. MAMARONECK, NEW YORK	
STOCK SIZE		BRONZE	
MATERIAL	WEIGHT PER PC.	BEARING, THRUST	
TYPE & TEMPER			
HEAT TREAT. SPEC.			
FINISH & SPEC. NO.			

ISSUE ITEM	CHANGED FROM	DATE	CN. NO.	DRAFTS CHECKER	ENG. APP.
A 1	BB-106-18 ADDED	10/1/63	10156	MA	WJF
TOLERANCES					
SCALE 1/16" = 1"					
DEC. DIM. ±					
FRAC. DIM. ±					
ANGULAR DIM. ±					
DRILL, PUNCH, COMMERCIAL STOCK SIZES AND MANUFACTURERS TOLERANCES ARE NOT INCLUDED.					