

REVISIONS				DATE	APPROVED
E.M.N.O.	DRAFT	CHKD	ZONE	LTR	DESCRIPTION
				X1	ITEMS 19 & 20 ADD.
					1-31-80
					2-10-81

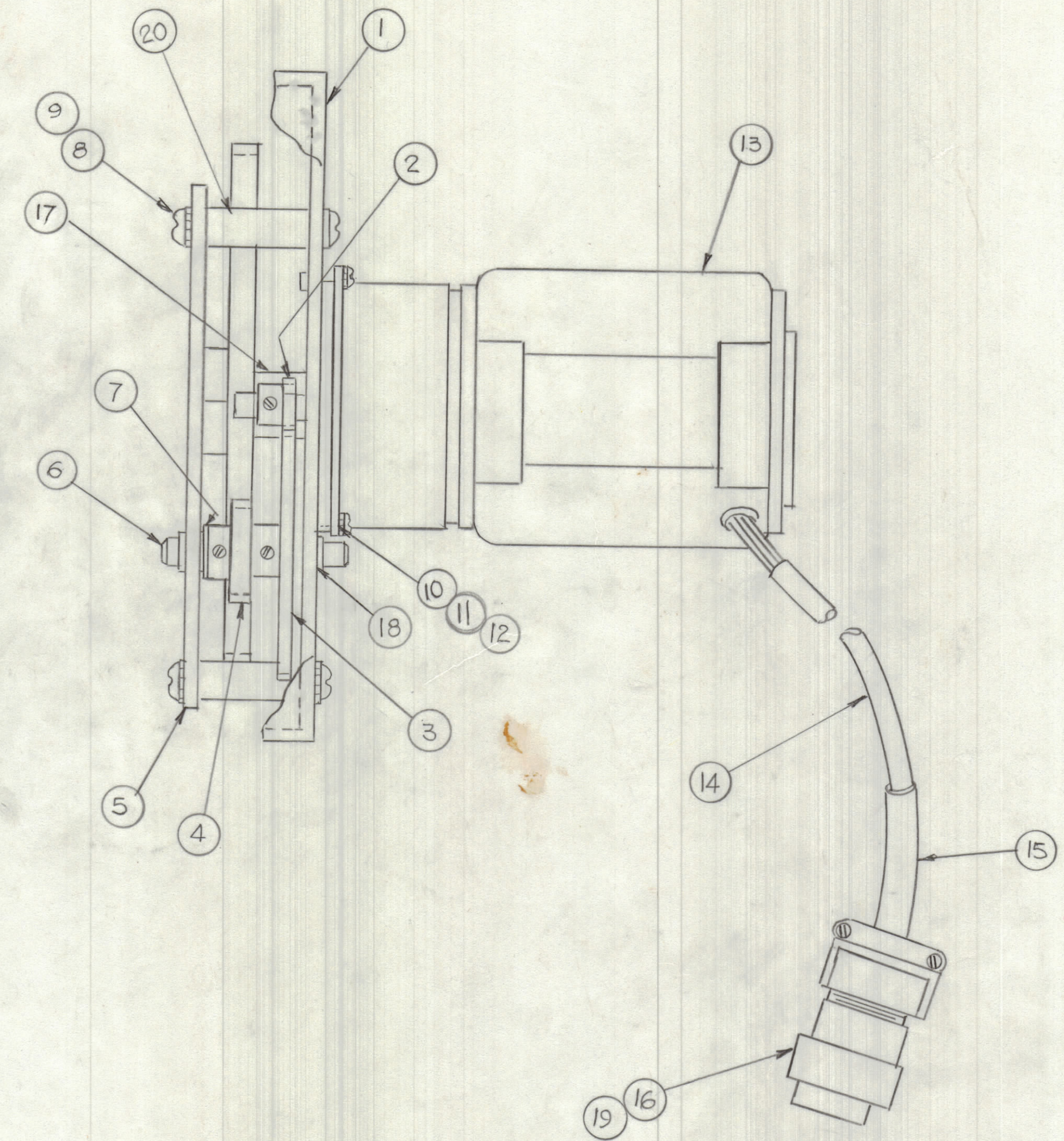
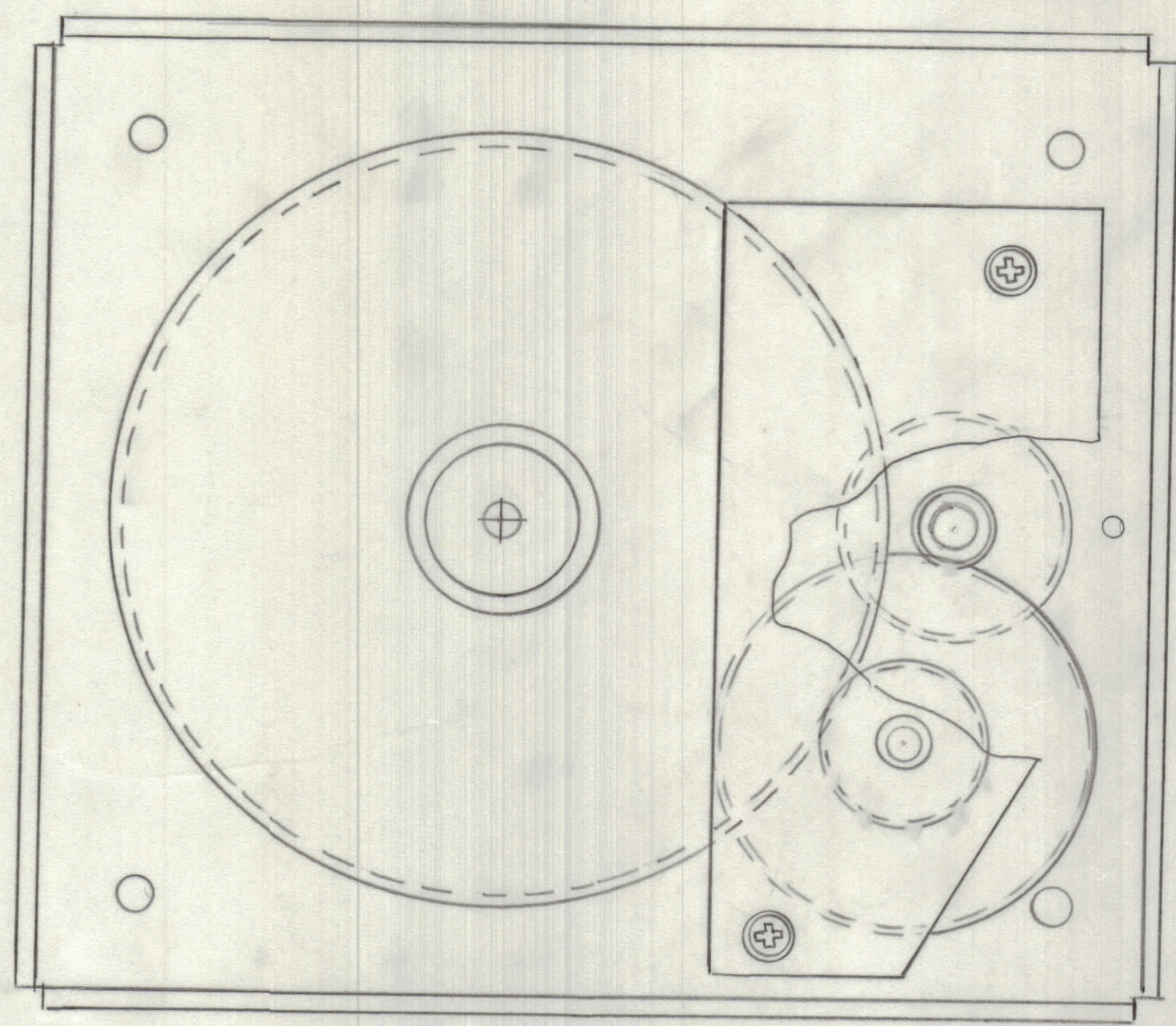

QTY. REQ.	ITEM	PART NO.	DESCRIPTION	SYMBOL
4	20	TE0832SS364	SPACER THREE	
1	19	MS3106A-1AS/PP	CONNECTOR	
1	18	BB117-6	BEARING, NYLON	
1	17	TE117-97	SPACER	
1	16	MS30576A	CAP CONN.	
1	15	MS3420-8A	BUSHING, CABLE	
5	14	PX100-1-249	INSULATION SLEEVING	
1	13	MO129	MOTOR	
3	12	LWE04MRN	LOCK WASHER EXT.	
3	11	CU155-2	CLAMP, MOTOR MTG.	
3	10	SCW0440PN6	SCREW, MACHINE	
4	9	LWE08MRN	LOCK WASHER EXT.	
4	8	SCBP0832PN6	SCREW, MACHINE	
1	7	FW101-2	WASHER, FLAT NYLON	
1	6	PM691RF1812A	SHAFT	
1	5	MS6950	PLATE, GEAR	
1	4	GR205-43	GEAR, SPUR, HUB	
1	3	GR205-10	GEAR, SPUR, HUB	
1	2	GR205-1	GEAR, SPUR, HUB	
1	1	PM1402	PLATE, BOTTOM, GEAR BOX,	

LIST OF MATERIAL				
FINAL APPROVAL	DATE	<b>THE TECHNICAL MATERIEL CORP.</b> MAMARONECK, NEW YORK  PA BAND SW. MOTOR		
MECH. DES.	DATE			
ELECT. DES.	DATE			
CHECKED	DATE			
DRAWN	DATE	SIZE	CODE/IDENT NO./DWG NO.	ISSUE
G.B.L.	1-31-80	D	82679 A5772	1
SCALE 1:1		SHEET OF		

HFTA-10K/525 LOCKWATER		
QTY / UNIT	MODEL USED ON	ASS'Y NO.
APPLICATION		
CODE		
<small>NOTICE TO PERSONS RECEIVING THIS DRAWING</small> <small>THE TECHNICAL MATERIEL CORPORATION claims proprietary right in the material disclosed hereon. This drawing is issued in confidence for engineering information only and may not be reproduced or used to manufacture anything shown hereon without permission from THE TECHNICAL MATERIEL CORPORATION to the user. This drawing is loaned for mutual assistance and is subject to recall at any time.</small>		

UNLESS OTHERWISE SPECIFIED DIMENSIONS ARE IN INCHES AND INCLUDE CHEMICALLY APPLIED OR PLATED FINISHES

TOLERANCES ON

DECIMALS	FRACTIONS
.X ± .05	± 1/64
.XX ± .01	ANGLES
.XXX ± .005	± 0° -30'

MATERIAL

FINISH