

REVISIONS						
ZONE	LTR	DESCRIPTION	DATE	E.M.N.NO	DRAFT	CHKD APPD
	X1	ADD POL. SYM TO XFMR'S & SYMBOLS	12/27/72		GE	
	X2	TITLE CHG.	1/13/73		GE	ES
	X3	R1 DELETED, JUMPER ADD.	1/19/73		GE	ES
	Ø	ORIGINAL RELEASE FOR PRODUCTION	1/29/73		Ø	

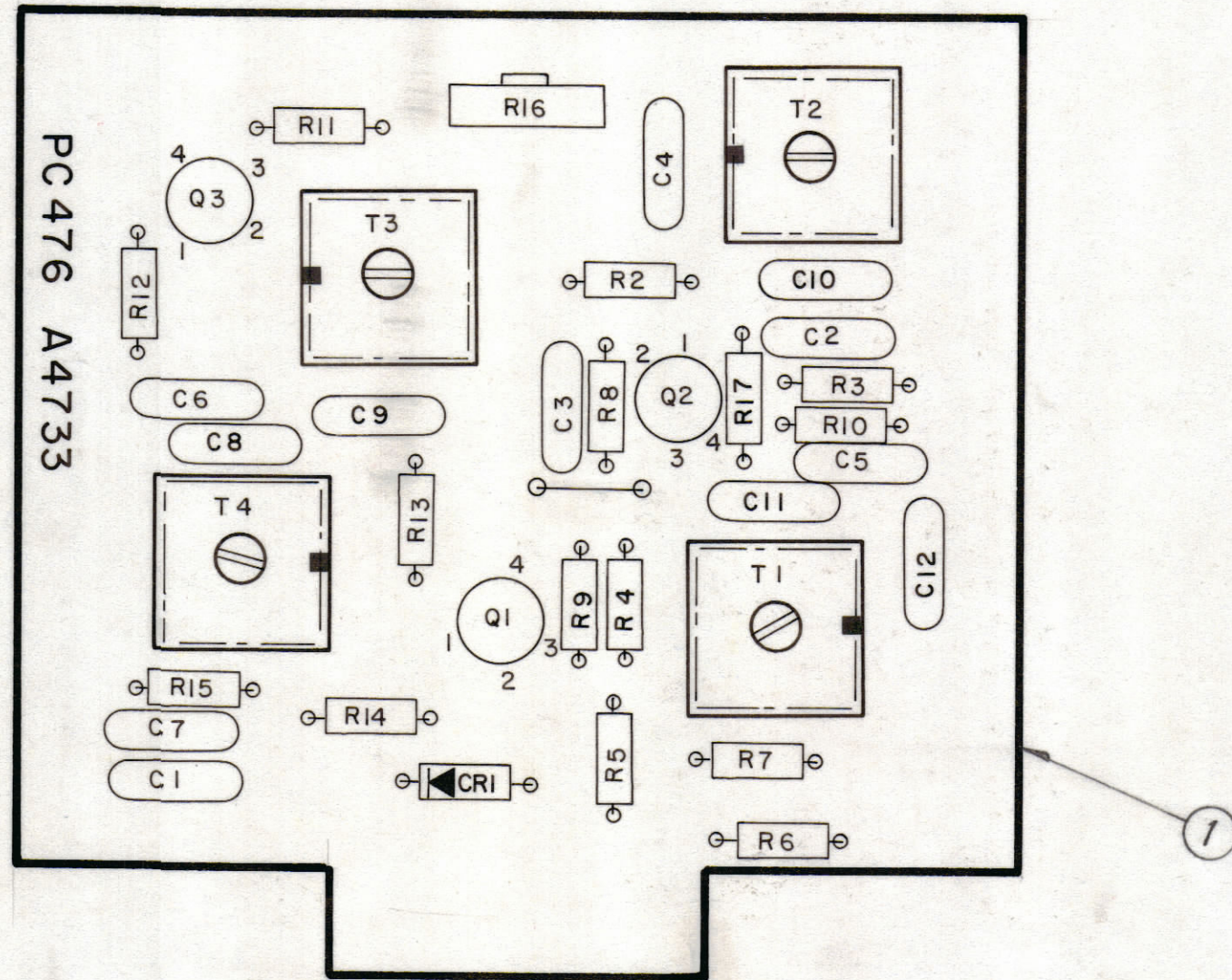

ASSEMBLY NOTES

1. TO MOUNT COMPONENTS, INSERT LEADS THROUGH HOLES.
2. CAUTION, WHEN APPLYING HEAT & SOLDER TO LEAD & FOIL.
3. CLEAN AND INSPECT AS PER SPEC. 5676.
4. FOR ELECTRICAL COMPONENT PART NUMBERS REFER TO NPL A4733.
5. USE SYMBOL NUMBERS FOR ASSEMBLY REFERENCE.

QTY. REQ.	ITEM	PART NO.	DESCRIPTION	SYMBOL
X	2	BS100	SOLDER TIN ALLOY	
1	1	PC476	PRINTED CIRCUIT BOARD	

O. POSE LIST OF MATERIAL

FINAL APPROVAL <i>[Signature]</i>	DATE 11/19/73	THE TECHNICAL MATERIEL CORP. MAMARONECK, NEW YORK ASSY. PRINTED CIRCUIT BD. EXCITER RF CARD			
MECH. DES.	DATE				
ELECT. DES.	DATE				
CHECKED	DATE				
DRAWN G. EVANGELIST	DATE 10/30/72	SIZE C	CODE IDENT. NO. 82679	DWG NO. A4733	ISSUE Ø
MATERIAL		SCALE		SHEET OF	
FINISH					

TM125		
QTY / UNIT	MODEL USED ON	ASS'Y NO.
APPLICATION		
CODE		
NOTICE TO PERSONS RECEIVING THIS DRAWING THE TECHNICAL MATERIEL CORPORATION claims proprietary right in the material disclosed herein. This drawing is issued in confidence for engineering information only and may not be reproduced or used to manufacture anything shown hereon without permission from THE TECHNICAL MATERIEL CORPORATION to the user. This drawing is loaned for mutual assistance and is subject to recall at any time.		

A4733