

ZONE		SYM	DESCRIPTION	DATE	E.M.N. NO.	DRAFT	CHKD	APPD
A			ITEM (1) WAS A-2532 - ASSY No. CHART ADDED	4-1-64	11172			

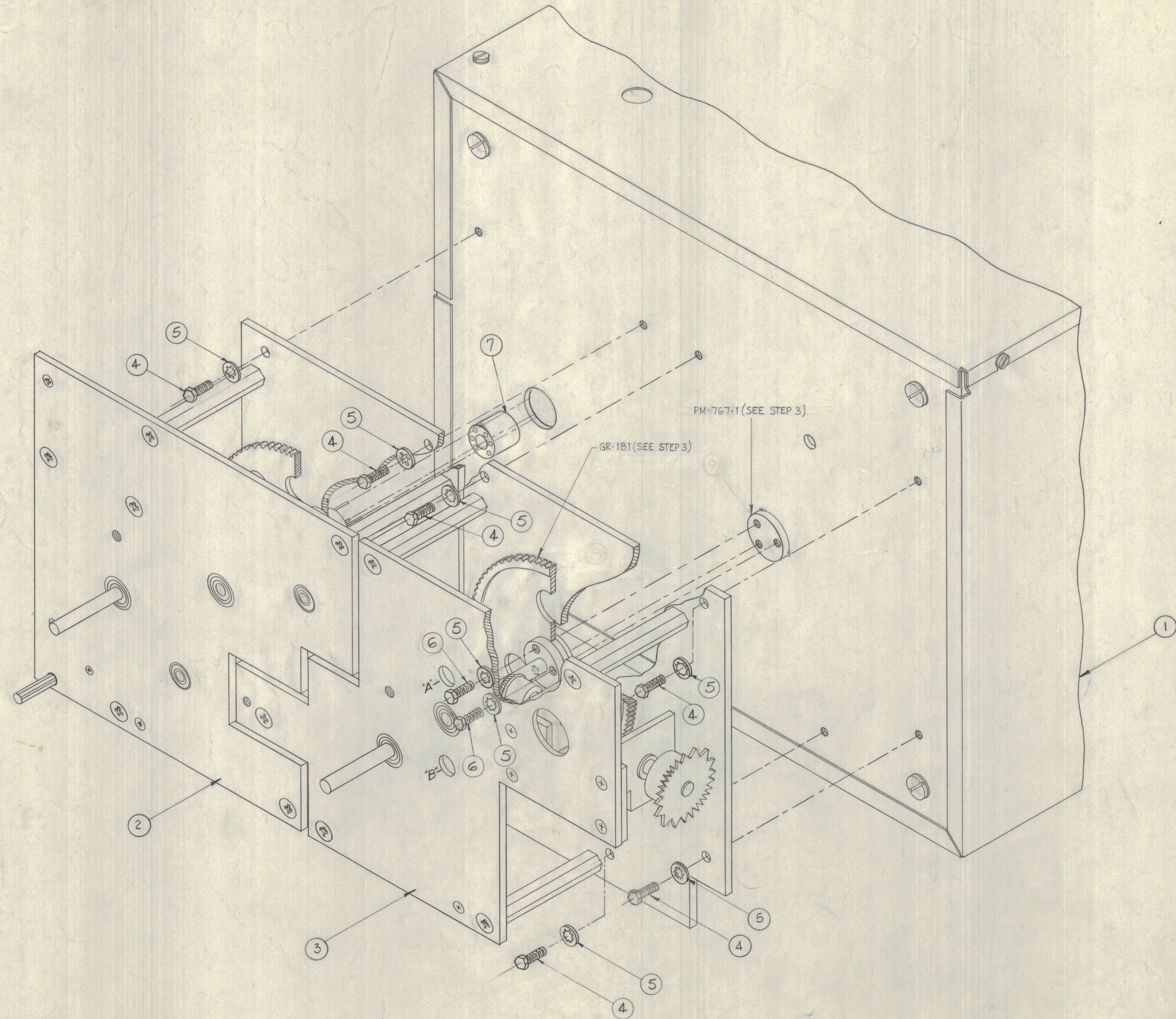

ASSEMBLY PROCEDURE

STEP 1 - LINE UP ITEM 7 INTO ITEM 1 BEFORE MOUNTING ITEM 2.
 STEP 2 - PUSH ITEM 2 FLUSH WITH ITEM 1, LINE MOUNTING HOLES & SECURE WITH ITEMS 4 & 5.
 STEP 3 - RELEASE SPRING ON DETENT ARM BEFORE MOUNTING ITEMS
 A - LINE UP GR-181 WITH PM-767-1.
 B - LINE UP 2 HOLES FROM GR-181 & PM-767-1 WITH HOLES "A" & "B" BEFORE INSERTING ITEMS 5 & 6.
 C - TIGHTEN BOTH SCREWS BY INSERTING SCREWDRIVER.
 STEP 4 - RE-TIGHTEN ALL SET SCREWS & MOUNTING SCREWS BEFORE MOUNTING FRONT PANEL.

ASS'Y No.	ITEM 1
A-3076-1	A-2532
A-3076-2	A-3593

A-3076-A

ITEM	QTY	DESCRIPTION	SYMBOL
1	1	GR-181	GEAR SPUR
1	7	PX-662-1	COUPLER, SHAFT, RIGID
3	6	SCHH08325514	SCREW, MACHINE
7	5	LW108M55	LOCK WASHER, INTERNAL TOOTH
7	4	SCHH0832556	SCREW, MACHINE
1	3	A-3058	BANDSWITCH GEAR ASS'Y.
1	2	A-3051	TUNING GEAR ASS'Y.
1	1	SEE CHART	TUNER ASS'Y.

REQ'D.		ITEM	PART NUMBER	DESCRIPTION	SYMBOL
KRUJ - ANGER LIST OF MATERIAL					
MATERIAL			THE TECHNICAL MATERIEL CORP. MAMARONECK, NEW YORK		
FINISH			TITLE TUNER & GEAR ASS'Y		
UNLESS OTHERWISE SPECIFIED DIMENSIONS ARE IN INCHES AND INCLUDE CHEMICALLY APPLIED OR PLATED FINISHES		DRAWN W TANTILLO	DATE 8-26-62	FINAL APPROVAL BP	
DECIMALS X ± .05 XX ± .01 XXX ± .005		CHECKED KRUJ	DATE 12/7/62	DATE 12/7/62	
FRACTIONS ± 1/64 ANGLES ± 0° 30'		ELECT. DES.	DATE	A-3076-A	
TOLERANCES		MECH. DES.	DATE	REV. LTR.	

NOTES

THE CONTENTS OF THIS DRAWING ARE THE EXCLUSIVE PROPERTY OF THE TECHNICAL MATERIEL CORP. ITS UNAUTHORIZED USE OR REPRODUCTION IN WHOLE OR IN PART IS STRICTLY FORBIDDEN.