

A-1249

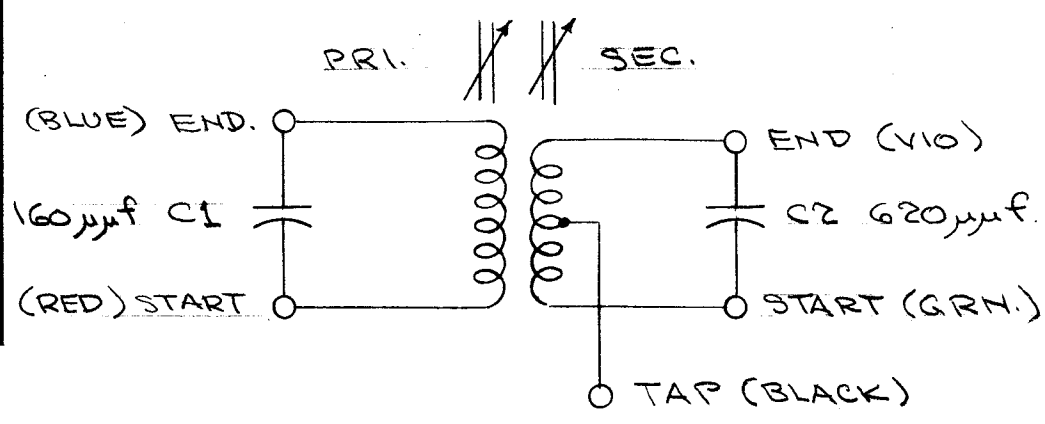

NOTICE TO PERSONS RECEIVING THIS DRAWING
 THE TECHNICAL MATERIEL CORPORATION claims proprietary right in the material disclosed hereon. This drawing is issued in confidence for engineering information only and may not be reproduced or used to manufacture anything shown hereon without permission from THE TECHNICAL MATERIEL CORPORATION to the user. This drawing is loaned for mutual assistance and is subject to recall at any time.

MODEL	SYM ITEM 11	SYM ITEM 9
FFRD - 1	C120	C122
- 2	C220	C222
- 3	C320	C322

Property of:
 THE TECHNICAL MATERIEL CORPORATION
 MAMARONECK, NEW YORK

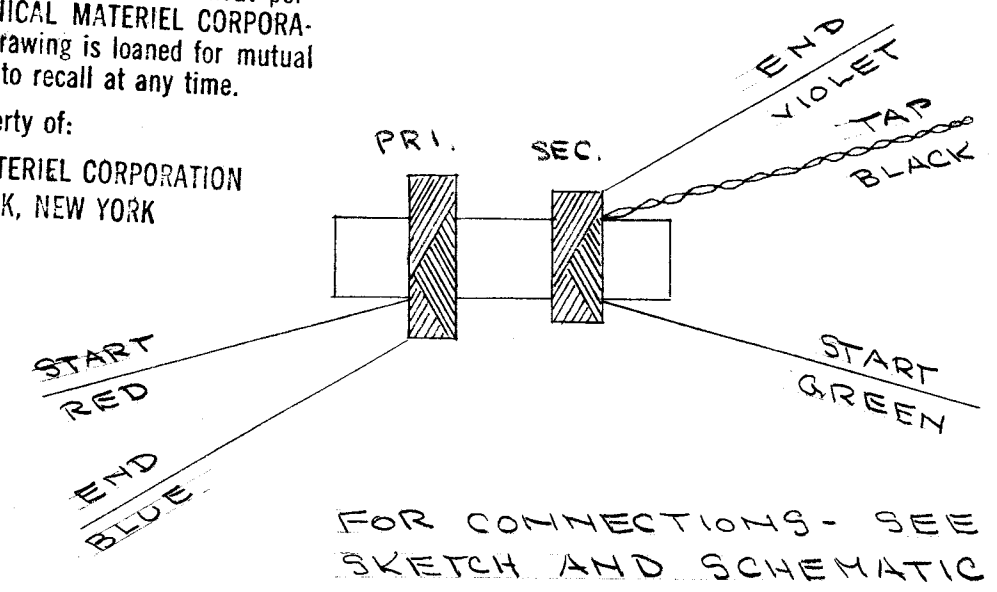

FOR CONNECTIONS - SEE ABOVE SKETCH AND SCHEMATIC

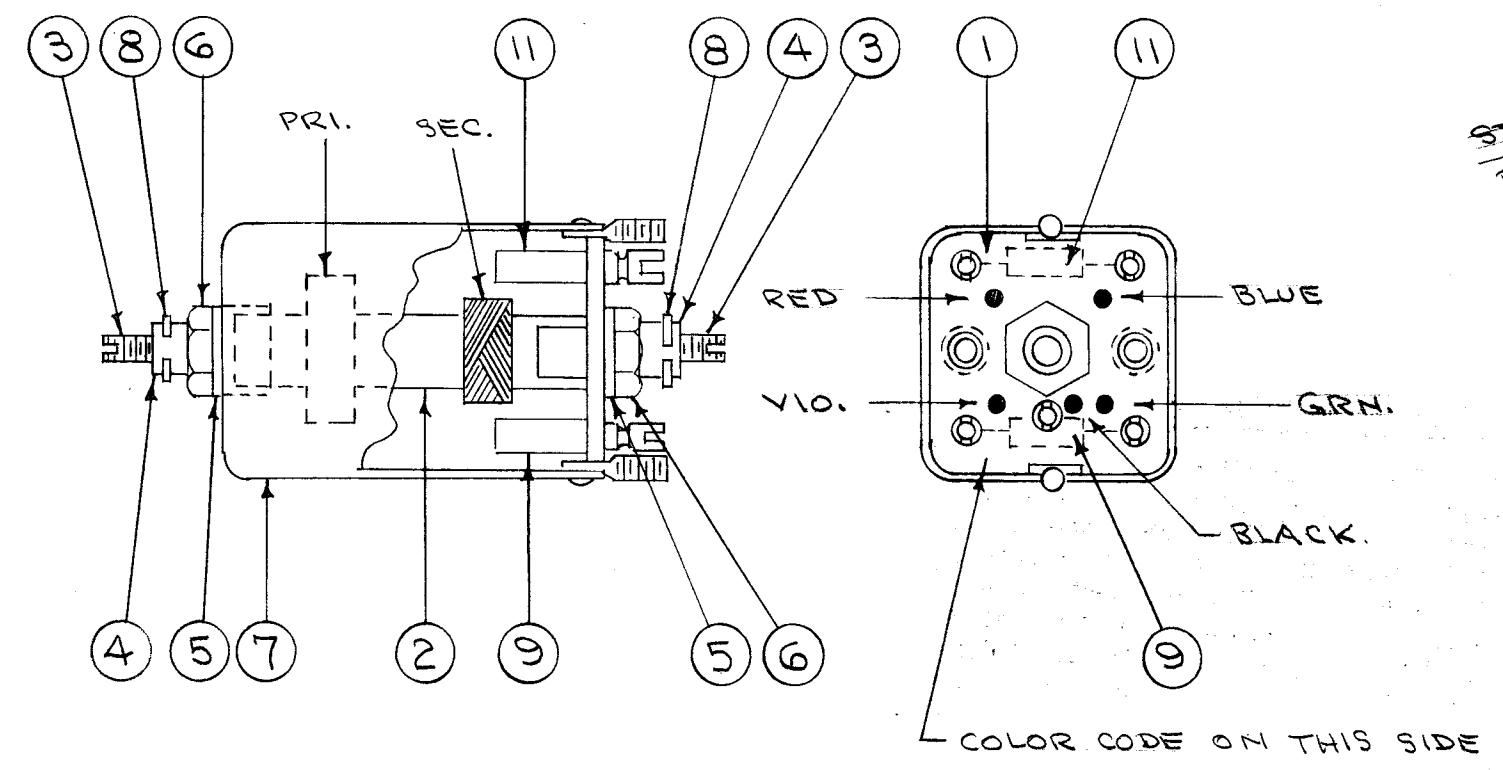
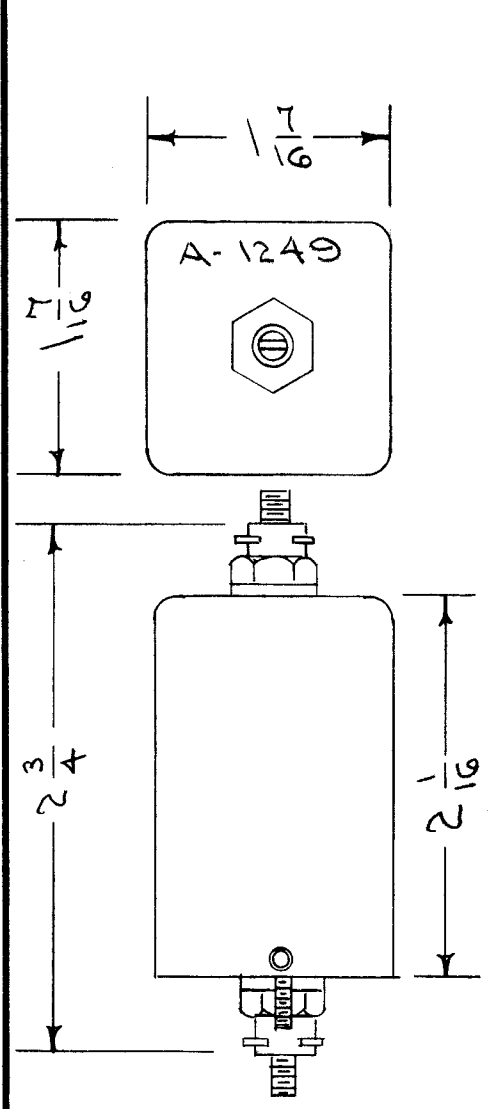

CIRCUIT APPLICATION - INTER STAGE
 FOR CHASSIS DRILLING PLAN SEE DWG. MS-119
 FOR ASSEMBLY OF BUSHINGS AND COIL FORM SEE SPEC. S-274.

STAMP CAN AS SHOWN - A-1249 ON TOP & TMC INSIANIA ON SIDE. COVER STAMPING WITH S-113 FUNGUS RESISTANT VARNISH.

1	11	CM20F161G03	CAPACITOR (C1)	SEE CHART
X	10	BS-100	SOLDER, SOFT	
1	9	CM20F621G03	CAPACITOR (C2)	SEE CHART
2	8	SP-102	SPRING LOCK	
1	7	A-136	CASE, I.F.	
2	6	NT-102	NUT, HEX	
2	5	LW125MRN	WASHER, LOCK	
2	4	SM-110	BUSHING	
2	3	CI-109-11	CORE, CERAMIC	
1	2	A-1248	TRANSFORMER, I.F.	
1	1	A-1247	I.F. TERMINAL BD. ASSY.	

REQ. ITEM	PART NO.	DESCRIPTION	SYMBOL
THE TECHNICAL MATERIEL CORP. MAMARONECK, NEW YORK			
STOCK SIZE		I.F. TRANSFORMER ASSY.	
MATERIAL		XTAL FILTER	
TYPE & TEMPER		HEAT TREAT. SPEC.	DRAWN
FINISH & SPEC. NO.		ELEC. DES. APP.	MECH. DES. APP.

A. J. J.

PLK. 3-27-56

A-1249 A

ISSUE	ITEM	CHANGED FROM	DATE	CH. NO.	DRAFTS	CHECKER	ENG. APP.
A		ITS. 5, 9, 11 P/N CHG	7-13-72	20787	GE	CL	CL

TOLERANCES: DEC. DIM. ±, FRAC. DIM. ±, ANGULAR DIM. ±

SCALE: MAXIMUM ALLOWABLE TOLERANCES HAVE BEEN DETERMINED AND ANY DEVIATIONS WILL BE CAUSE FOR REJECTION. REMOVE ALL BURRS AND SHARP EDGES

REQ. PER UNIT	MODEL	PROJECT NO.	ASS'Y. NO.	DATE
1	FFRD-1-2-3	E-458-P		3-15-56

USED ON