

A 1192 D

WINDING -  
2 3/4 TURNS WI-127-10, CLOSE WOUND  
AS SHOWN.

TEST DATA.

TEST ONLY FIRST COIL OF EACH RUN,  
ALL REMAINING COILS MAY THEN BE  
PASSED BY VISUAL INSPECTION.

L - .28 - .30  $\mu$ h  
Q - 230 OR GREATER  
F - 25 M.C.

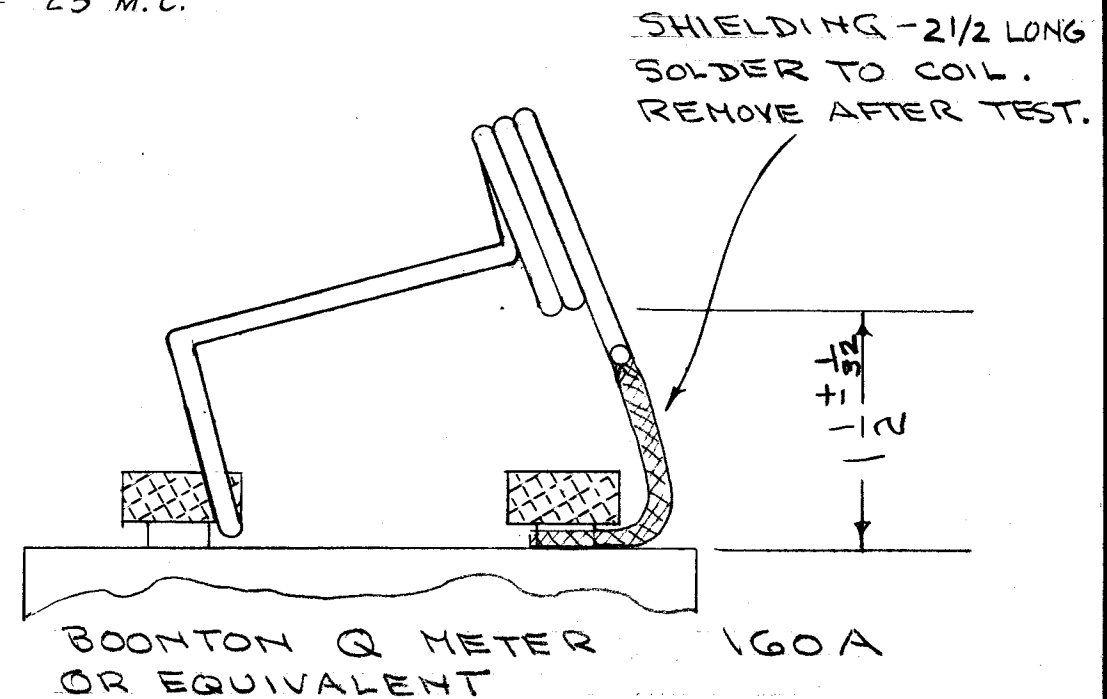
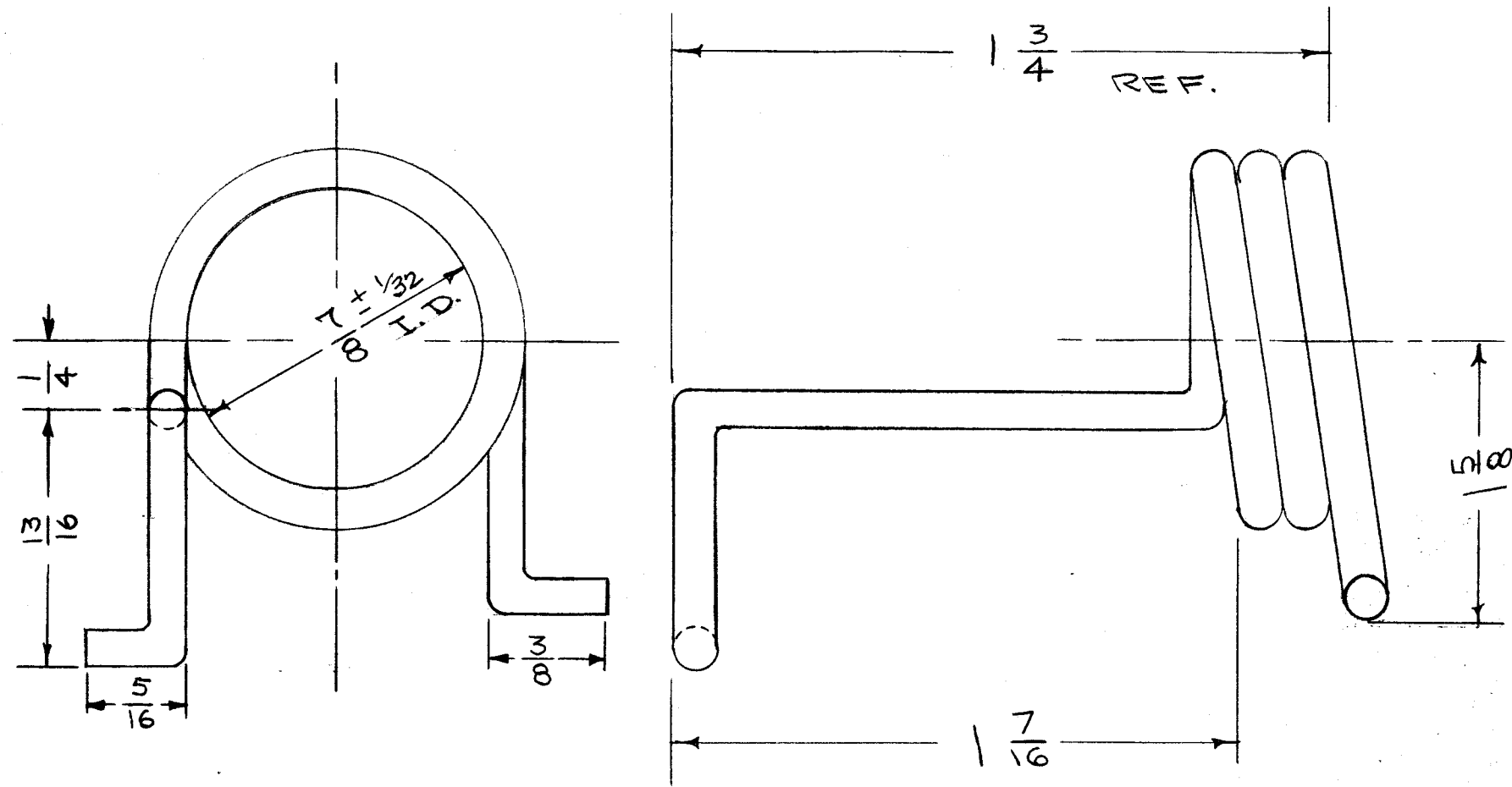

NOTICE TO PERSONS RECEIVING THIS DRAWING

THE TECHNICAL MATERIEL CORPORATION claims proprietary right in the material disclosed hereon. This drawing is issued in confidence for engineering information only and may not be reproduced or used to manufacture anything shown hereon without permission from THE TECHNICAL MATERIEL CORPORATION to the user. This drawing is loaned for mutual assistance and is subject to recall at any time.

Property of:

THE TECHNICAL MATERIEL CORPORATION  
MAMARONECK, NEW YORK

| REQ. ITEM  | PART NO.  | DESCRIPTION    | SYMBOL        |
|--|-----------|----------------|---------------|
| X 3  | BS-100    | SOLDER, SOFT   |               |
| X 2  | WL-103-2  | SHIELD         |               |
| X 1  | WI-127-10 | WIRE           |               |
| THE TECHNICAL MATERIEL CORP.<br>MAMARONECK, NEW YORK |           |                |               |
| STOCK SIZE   |           |                |               |
|  |           | COIL, Assy     | 16-32 Mc      |
|  |           | MATERIAL       | L 214 - MULT. |
|  |           | DRAWN          | A. J. J.      |
|  |           | CHECKED        | WL            |
|  |           | FINAL APPROVAL |               |
|  |           | A 1192 D       |               |

| ISSUE ITEM | CHANGED FROM                   | DATE     | CH. NO. | DRAFTS | CHECKER | ENG. APP. |
|------------|--------------------------------|----------|---------|--------|---------|-----------|
| D          | ADD TOLS.                      | 10-23-67 | 10549   | HLL    | WJ      | OP        |
| C          | DIM. 1-5/8 WAS 1-1/8           | 4-21-67  | 18135   | M      |         | FB        |
| B          | LEADS RELOCATED & DIMS REVISED | 11/3/66  | 17150   | RME    | QCB     |           |
| A          | TEST PROCEDURE CH. Q-WAS 260   | 2/10/56  | 1       | JAK    | O.P.    | A.J.J.    |

| TOLERANCES           | SCALE:   | 1             | RTF-2 | MULT        | 11-20-58   |
|----------------------|--|---------------|-------|-------------|------------|
| DEC. DIM. $\pm$      | MAXIMUM ALLOWABLE TOLERANCES HAVE BEEN DETERMINED AND ANY DEVIATIONS WILL BE CAUSE FOR REJECTION. REMOVE ALL BURRS AND SHARP EDGES | 1             | RTF   |             | 12-27-55   |
| FRAC. DIM. $\pm$ 1/8 |  | REQ. PER UNIT | MODEL | PROJECT NO. | ASS'Y. NO. |
| ANGULAR DIM. $\pm$   |  |               |       |             | DATE       |

USED ON